

QUICK START GUIDE

SET-UP p.1

UTILIZATION p.20

MAINTENANCE p.58

TROUBLESHOOTING p.67

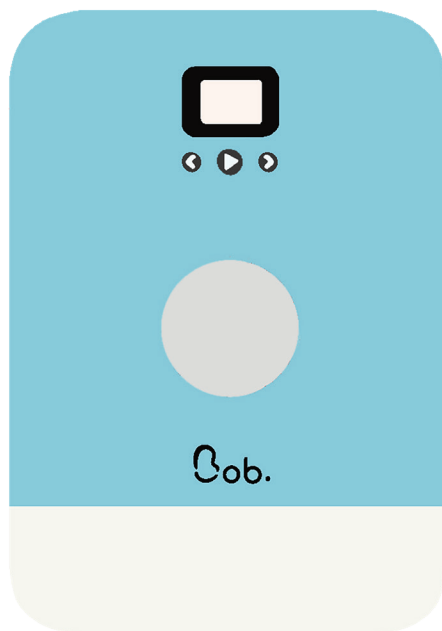

Everything about your Bob.

DAAN.TECH

Designing Meaningful Things
www.daan.tech

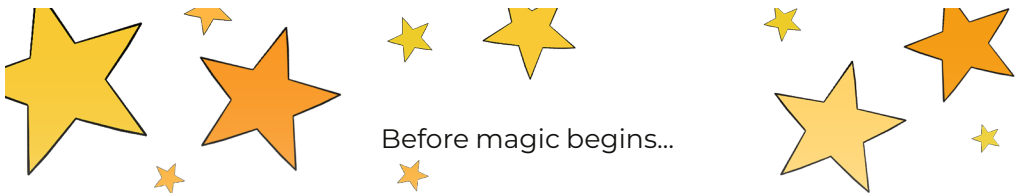

Before magic begins...

THANK YOU! YOU ARE A NEW MEMBER OF THE BOB COMMUNITY!

Today is not an ordinary day because today you decided to throw in the sponge and to adopt Bob instead!

If you want to remember this day, please note the date here:

.....

From now on, a new era begins: an era of ease in the wonderful world of always clean dishes.

Bob is not an ordinary dishwasher which is why we have designed this guide to support you discovering Bob

Your Bob is unique, just like you! You can find its unique identification number on its back.

Please note your Bob's ID here:

Bob.#

We are convinced that your Bob will give you as much pleasure as it has given us when we designed, created and tested it in our French factory. We have engaged in creating the best user experience and hope you enjoy every day with Bob.

Take a break now, throw away your sponge and join us into a world with Bob!

The Daan Tech Team

Table of content

1 | QUICK SET-UP GUIDE

1 Delivery, Unpacking and Transport	2
2 Scope of application and place of use	3
2.1 Scope of application	3
2.2 Place of use	4
3 Set-up and Connections	5
3.1 Water inlet	5
3.2 Water outlet	6
3.3 Anti-theft Bob lock	8
3.4 Power plug	9
4 Getting started	10
5 Capacitive door opening	15
6 Configure your basket	16
7 Discovering the Bob cassette	17
8 Bob is ready !!	19

2 | QUICK UTILIZATION GUIDE

1 Interface	21
1.1 Navigate through Bob OS interface	21
1.2 Menu options of the home screen	22
1.3 Settings	24
1.5 Bob cassette menu	27
1.6 Bob ultraviolet program	28
2 Basket Set-up	29
2.1 Maximum size of plates	29
2.2 Recommendations on how to place kitchenware inside Bob	30
2.3 Basket configuration according to your needs	32
3 Wash cycle	39
3.1 How a wash cycle works	39
3.2 Standard programs	42
3.3 Creating and deleting a custom program	44
4 Bob cassette and the distribution of detergents	46
5 Manage your Bob from your Daan Tech account	51
6 Bob+	53

3 | QUICK MAINTENANCE GUIDE

58

Product description	59
1 Filters	61
2 Heating Elements	63
3 Tubes	64
4 Cover and screen	65
5 Spray arm	66

4 | QUICK TROUBLESHOOTING & AFTER SALES SERVICE GUIDE

67

1 List of possible issues	68
2 Repair and customer service	73
Product sheet	74

Safety instructions

PLEASE READ THE SAFETY INSTRUCTIONS CAREFULLY BEFORE USING BOB - THE MINI DISHWASHER - AND KEEP THEM FOR FUTURE REFERENCE.

- Bob, the mini dishwasher, is intended to be used as a domestic home appliance and for similar purposes, including: professional environments such as kitchenettes used by personnel at the office and for use in any residential room, including hotels and motels.
- Bob can be used from the age of 8 years as well as by people with physical or mental disabilities as long as a proper supervision is guaranteed or if the former has been provided with the following safety guidelines and is aware of the possible risks involved with the usage of Bob. Children shall not play with Bob. Cleaning and maintenance of the appliance shall not be carried out by unsupervised children.
- If the power cable is damaged, it shall be replaced either by the manufacturer, its after sales service or by any similarly qualified person in order to avoid hazard occurring.
- To inform yourself how and when to clean the appliance, please refer to the **Quick maintenance guide page 58**.
- The door shall not remain fully open to avoid potential incidents, yet it is highly recommended to slightly leave it open guaranteeing air circulation and thereby decreasing standby energy consumption.
- **WARNING:** Knives and other cutlery must be put in the cutlery basket module with its blades and pikes pointing downwards.
- Only the new tubes and power cable provided with Bob shall be used while used ones should not be used.
- Information on how to load the basket is provided within the section **Configuration of the basket and options** on page 29.
- The pressure within the water inlet shall be between 0,05 Mpa and 1 Mpa.
- The power plug shall be easily accessible after Bob's set-up.
- According to standard EN50242, this dishwasher shall not be used to clean more than two place-settings.

IMPORTANT SAFETY GUIDELINES:

- Bob, the mini dishwasher, shall only be used to clean plates, glasses, forks, and knives and sanitize objects with UV-C (if and only if you added the UV-C sanitization option).
- Never unplug Bob from the power network by pulling the power cable, always pull the power plug instead.
- Before plugging Bob to the power network, please check if the tension recommended on the type plate matches the one of the power network. Bob has to be placed on a stable and/or even surface. Daan Tech is not liable for damage resulting from the use of Bob on an uneven and/or unstable surface.
- Do not touch Bob when your hands or feet are wet.
- Never open the door during a wash cycle. You may be exposed to steam or hot water. To pause an ongoing program, please press  and wait for 3 seconds.
- Do not let children climb on Bob's door and also do not place heavy objects on the door while it is open. It may result in the dishwasher tipping over.
- Do not put living creatures, animals or pets inside Bob! ;)

QUICK SET-UP GUIDE

1

1 | DELIVERY, UNPACKING AND TRANSPORT

Here we go: Your Bob has just been delivered.

Open the package and take Bob out using the provided protection bag.



This bag can be reused in your everyday life (shopping, laundry, etc...)



100% recycled packaging

To carry Bob, please use the handles located at the bottom of the appliance.



Empty, Bob only weighs 10 kg (22 lbs) and is easy to carry.

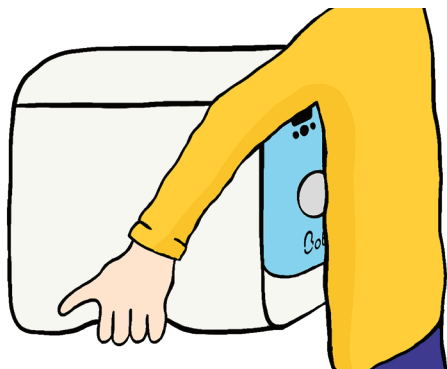

Here are the handles!

Please keep Bob's packaging for future transportation purposes and for the after sales services.



Fold the delivery box and place it in a dry place (e.g. below your bed or inside a wardrobe).

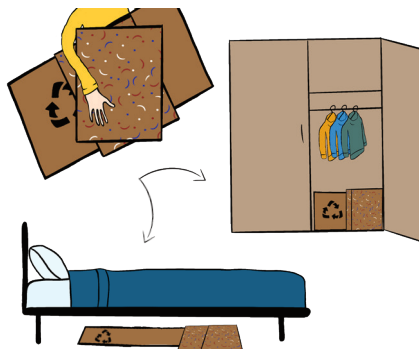

2 | SCOPE OF APPLICATION AND PLACE OF USE

2.1 | Scope of application

Because of its small size, Bob fits everywhere!



At home

On vacation

At the office

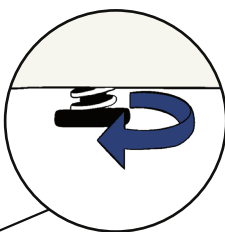
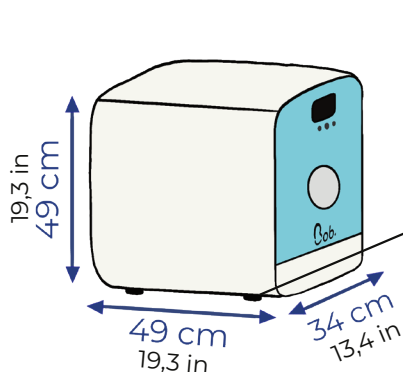

Bob might be humid inside when you receive it. In fact, every Bob has been tested before shipping (empty cycle with clear water). Therefore, there might still be some traces of residual water.

Bob's 4 feet can be adjusted up to +1cm (+0,4in) to ensure that it is in a perfectly horizontal position.

Warning: Bob's inclination shall not exceed 2° in order to avoid possible flooding.

Precautions against frost:

Bob shall not be stored in a place with a temperature lower than 0°C . If such a situation could occur, ensure that Bob has been drained using the draining program within the settings menu (refer to page 25) and remove the inlet water hose.

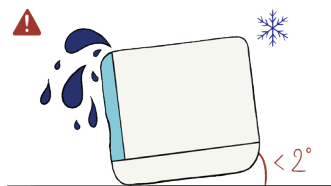

2.2 | Place of use

You can place Bob anywhere you want, it is the smallest dishwasher ever!

3 options

On top of a shelf



The shelf should withstand a weight of 25 kg (55,1 lbs) (weight of Bob + water + dishes).

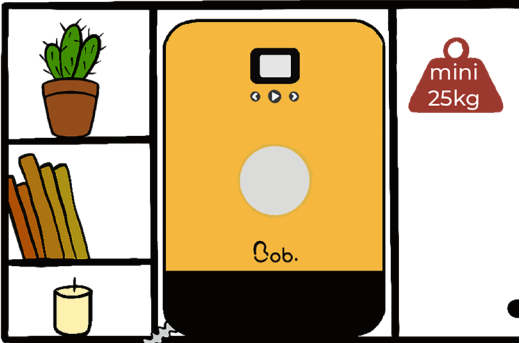

On a work surface



The provided water outlet's length is 1m50.



Place Bob on a water-resistant surface to avoid stains.
When filling Bob's water tank or taking out dishes, drops of water may end up on the work surface.

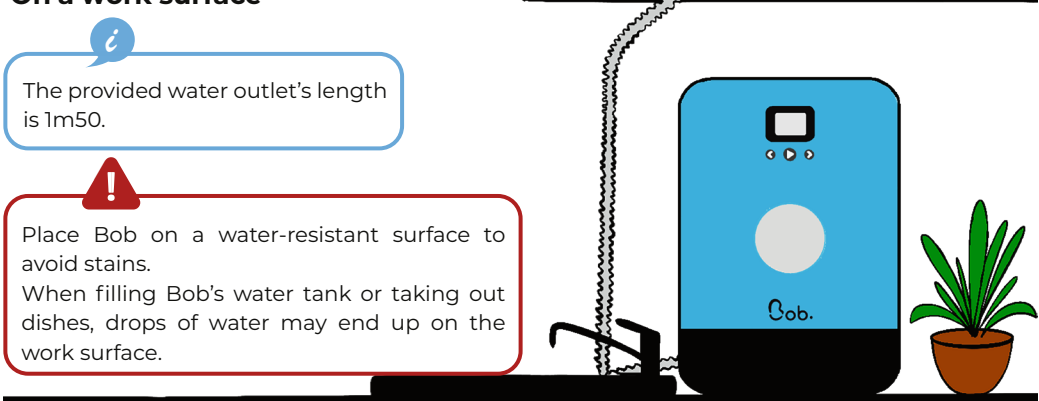

Below the sink



During a cycle, please make sure that nothing hinders the automatic opening of the door at the completion of the program.

Warning : In the long run, the steam released during the opening of the door may damage wooden surfaces.

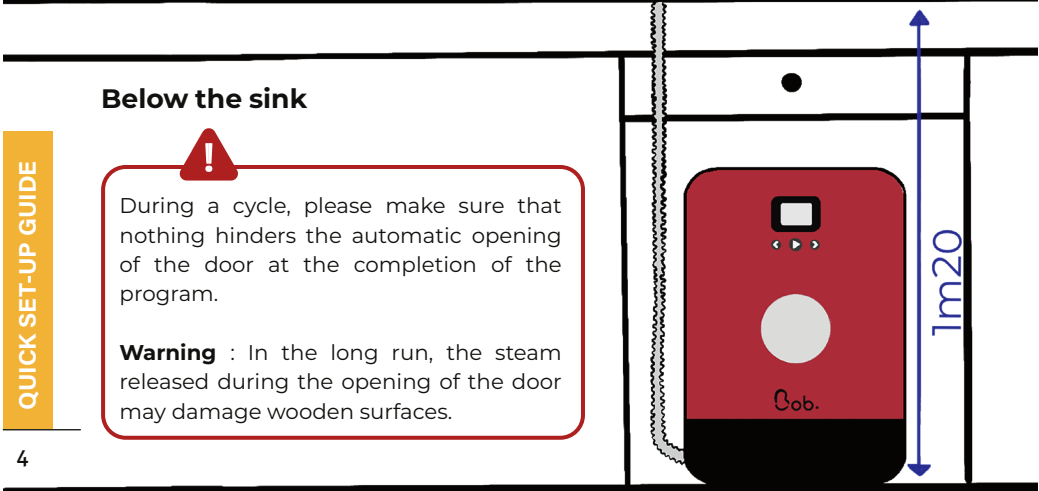

QUICK SET-UP GUIDE

3 | SET-UP AND CONNECTIONS

3.1 | Water inlet

2 available options

1 Bob.easywater

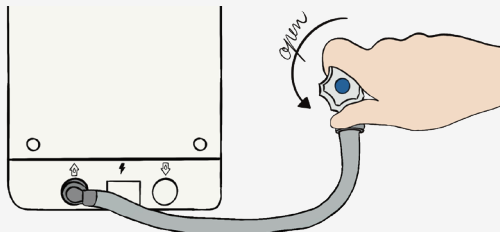

Plug the water inlet hose Bob.easywater on one side to the back of Bob and on the other side to a water inlet via a 19 mm threaded end (3/4 inch) **and make sure the connection is firmly tightened.**



WARNING: Close the water supply tap after each use of Bob.



Daan Tech offers Bob.easywater inlet hoses on its website.

Please scan the QR code to check it out. .



2 Bob.carafe

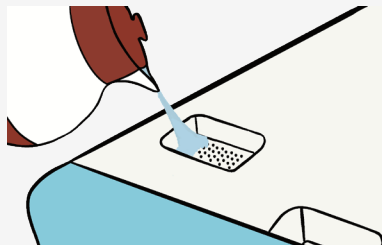

Using Bob as an autonomous free-standing dishwasher thanks to its **built-in water tank**. In this case, no water inlet hose is needed! Please use Bob Carafe to quickly fill the water tank! Bob can be filled with either cold or hot water up to 60°C.



Please always fill the water tank before use (4L capacity) until you hear the signal sound that indicates that the tank is full.



Do not overfill the tank! If you fill in more than the water tank capacity (4 L), the excess water will escape into Bob's main interior.



Daan Tech offers 3 colours of Bob.carafe.

Please scan the QR code to check it out.





Warning: Do not block the water inlet of the water tank. **This must always remain free.**

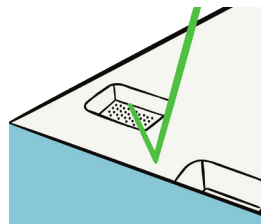
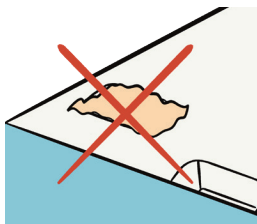

3.2 | Water outlet

Plug the water drain hose to the back of Bob.



Warning: To prevent leaks, please use the provided clamp to fix the water outlet.



Tighten the clamp screw with the supplied Bob screwdriver/bottle opener and use the key ring to tighten the screw! Then attach it to your key ring. Pretty handy, as it will from now on follow you everywhere as a bottle opener or screwdriver.

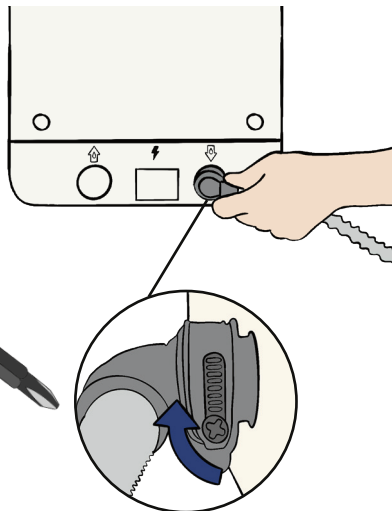
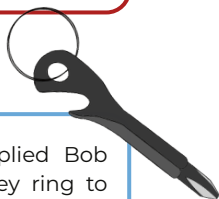

2 options for evacuating the waste water

1 Siphon drain pipe

Connect the water outlet hose to a **siphon drain pipe** (usually accessible under the sink)



Warning: The waste water coming out of Bob can reach high temperature of up to 70°C.

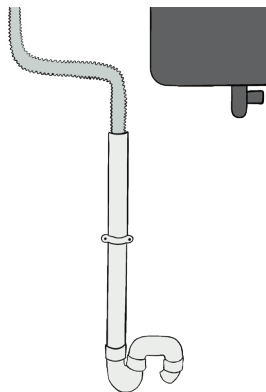

Install the water outlet drain hose either in a fixed or flexible mode by using the Bob.easyfix equipment provided by Daan Tech.

Fixed installation

Place the drain hose **directly in your sink** and fix it with the equipment provided by Daan Tech.

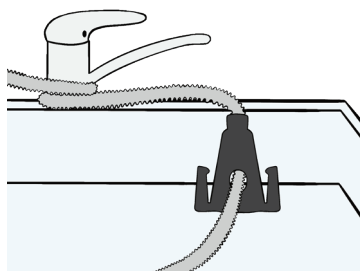
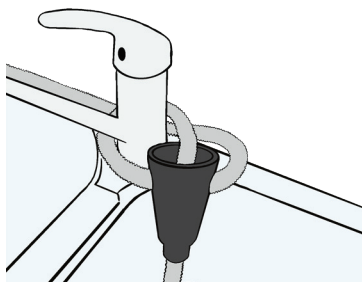

Flexible installation

Place the drain hose **in a container** (jerrican, bucket, etc...)

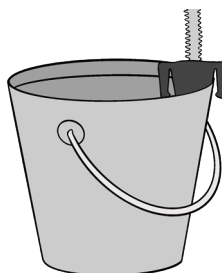
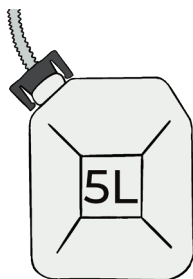

To avoid possible flooding, the container shall have a capacity of at least 4L.

If you have found a new way to fix Bob's water outlet Bob.easyfix **please send us a picture.**

3.3 | Anti-theft Bob.lock

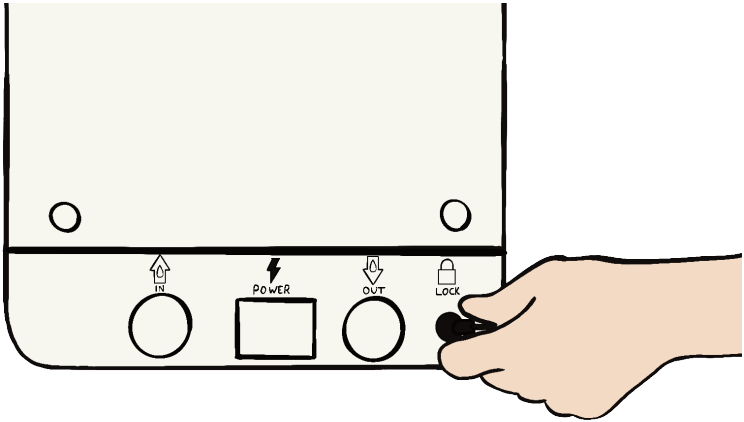

Because your Bob is precious, it comes with a built-in anti-theft feature. All you need to do is lock the anti-theft device on the back with one of the two provided keys.

Bob.lock Anti-theft devices are available on Daan Tech's website.

Please scan the QR code to check it out.

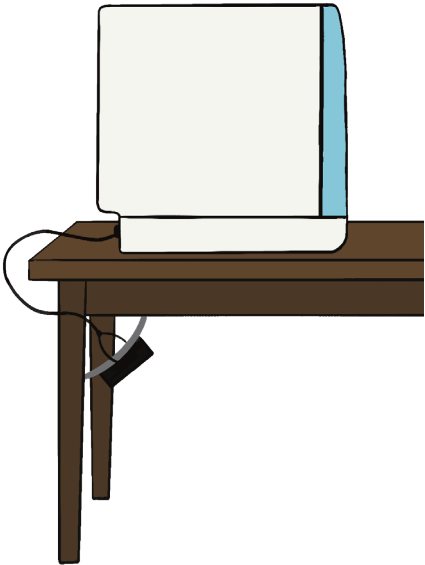

3.4 | Power plug



WARNING: Please turn the power supply off before installing Bob.

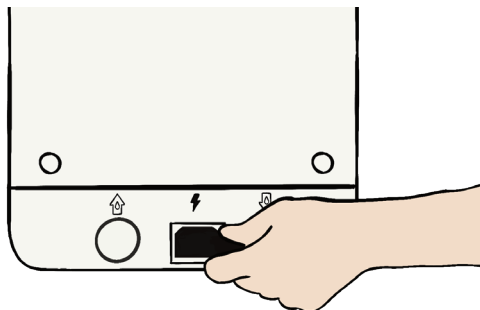

Connect the power cable to Bob's back.

Connect the power cable to a 220-240V 50-60Hz plug.

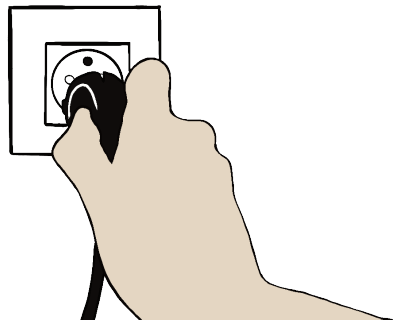

Before you connect Bob to the power supply, please make sure that the voltage on the type plate corresponds to the voltage of your power supply.

The appliance must be placed on an even and stable surface. Daan Tech is not liable for any damage caused by placing the device on an uneven and/or unstable surface during use.

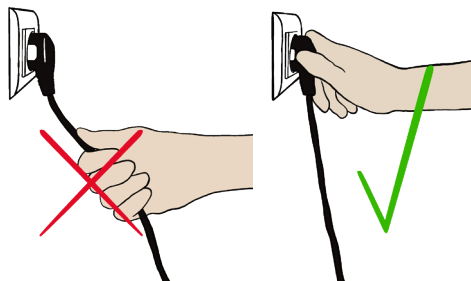

Do not plug or unplug by pulling the cord, **but always pull the plug directly.**

4 | GETTING STARTED

When you turn Bob on for the first time, you need to configure it.



Bob OS is the operating system developed by Daan tech. Its colourful interface allows you to easily navigate through the different menus.

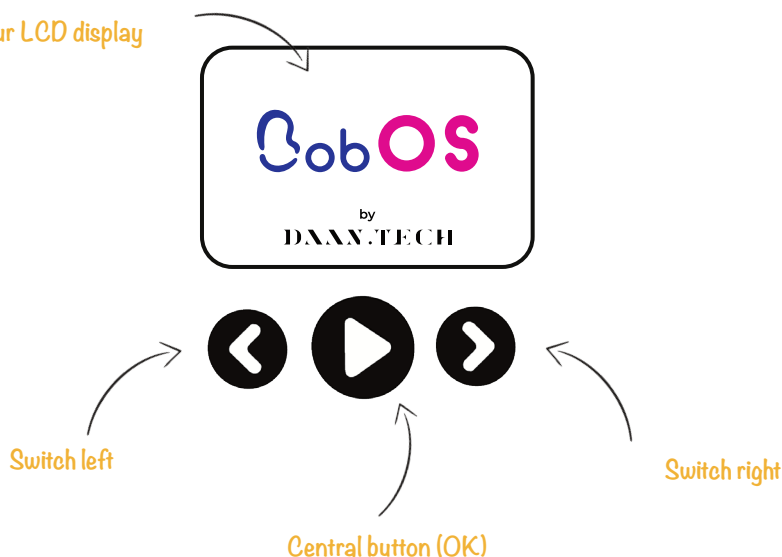

Bob OS also allows you to connect Bob to the Internet via Wi-Fi, allowing for future evolutions which will be accessible through updates enabling new features.

2.4" colour LCD display



How to choose an option?

To select an option, scroll from left to right until the icon indicating the desired option appears and press the central button to choose it.

A confirmation message appears, which you can either confirm using  or reject using . The latter also redirects you to the previous screen.

Choose your language



English

Step 1: Choose your language.

Bob speaks 6 languages: English, French, Spanish, Italian, German and Dutch.



Once you have chosen your language, a message pops-up asking you to agree with the Terms and Conditions. To be able to use Bob, you have to agree to our Terms and Conditions which you can find on the website.

Please scan the QR code to read the Terms and Conditions.



Step 2: Choose the water supply mode

2 options:

Water supply mode



Water inlet pipe

Water supply mode



Built-in water tank

- **Use the water inlet pipe** (available on our website). **The water tank is automatically filled before each cycle**, so there is no need to fill it manually. It is the preferred choice if you use Bob as a built-in dishwasher or if you have close access to a water supply.
- **Use the built-in water tank:** convenient, **because it makes Bob completely autonomous to use wherever you are.** Fill the built-in water tank with Bob Carafe (available on our website). This is the preferred choice if you intend to regularly move Bob around or if you do not have access to a water inlet.



Connect Bob?

Access many more functionalities by connecting Bob to your Daan Tech account



Step 3: Add new features to Bob by pairing Bob to your Daan Tech account (free & simple on www.daan.tech)

To discover the benefits of pairing Bob to your account, please refer pages 52 and 57.



Join network

Connect with a smartphone or computer to the Wi-Fi network **BOB_XXXX** with the following password **XXXXXXXXXXXX**

Step 1/3

Connect your smartphone or a computer **to the Wi-Fi network “Bob_XXXX”** with the following password: **XXXXXXXXXXXX**

Once you are connected, select  to go to the next step.



If you do not manage to connect Bob, please restart your smartphone or computer.

On the Internet

Enter in your browser **10.10.0.1**

Step 2/3

Enter the following in the address bar of your web browser :

10.10.0.1

Once the website is loaded please select  to proceed to the next step.

Choose Wi-Fi

Choose a Wi-Fi network to connect to Bob

Step 3/3

In your web browser on your smartphone or computer, **select the Wi-Fi network** to which you want to connect Bob.



Please use a private network secured with a password.

If required, a video to guide you through the steps of the Wi-Fi connection is available on our website.

Please scan the QR code to check it out.





Bravo

Bob is now connected to Wi-Fi

Once the Wi-Fi network is selected, Bob connects and a validation screen appears.

BRAVO, your Bob is now connected to the internet. Now, you need to pair it to your Daan Tech account.

Bob ID:

00:00:00:00:00:00

Login to your account on www.daan.tech and enter this ID in the "Manage my Bob" tab

Your Bob is unique and has therefore a **unique ID or MAC address** as follows:

00:00:00:00:00:00

Connect to your Daan

Tech account on www.daan.tech

In your account "**My account**"

Select the "**Manage my Bob**" tab.

Enter the unique ID of your Bob in the dedicated field.

Validate



If the connection is lost during the pairing process, an error message is displayed.

You can either try again or cancel your connection and consequently not connect Bob to your account (for more information, please refer to page 52).

On your web browser

Manage my Bob tab

Here you can connect Bob

QUICK SET-UP GUIDE

Confirm?

Is your e-mail correct?

example@gmail.com



To complete pairing Bob to your account, **you need to confirm your email address.**



Bravo

Bob is now connected to your Daan Tech account

BRAVO! Your Bob is now paired with your Daan Tech account.



If your Bob is connected to WIFI, we will automatically push the latest updates: Bob OS.

You will receive an email when a new update is available.

Your Bob will then automatically be updated when you restart it.

5 | CAPACITIVE DOOR OPENING

When you touch the door, it automatically opens.

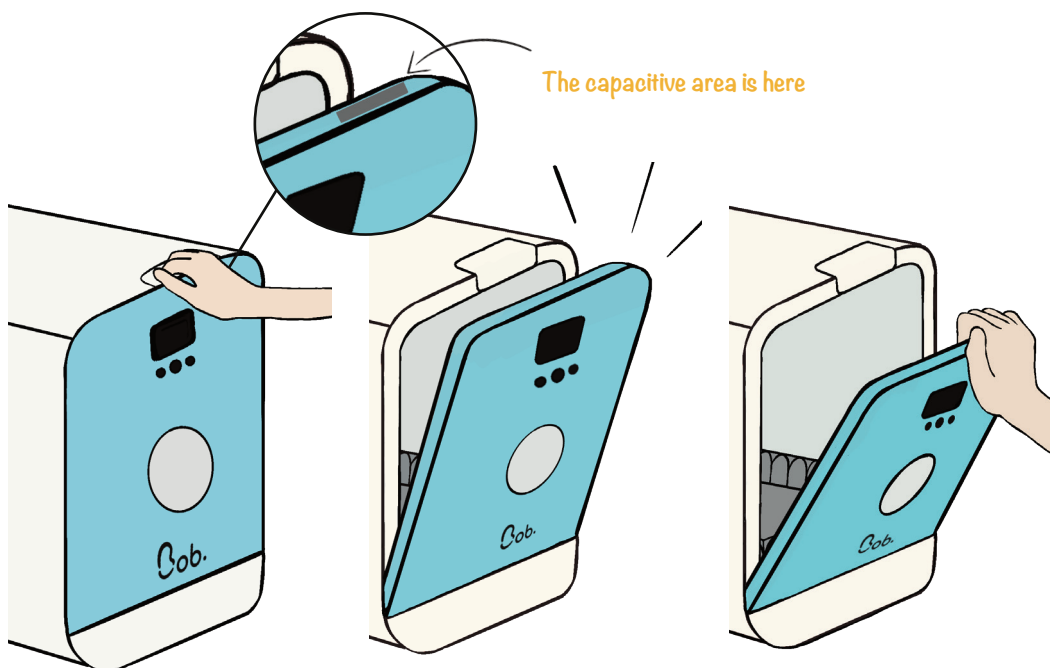

Convenient, **because you can open the door** of your Bob **with your elbow**, for instance, if your hands are dirty!

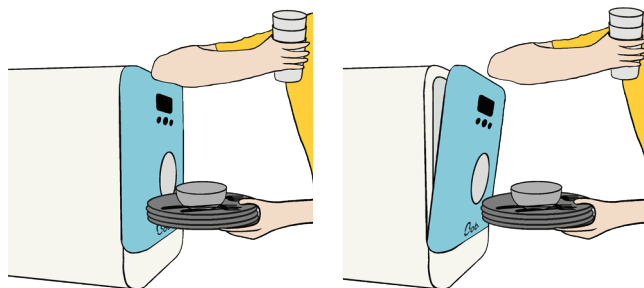

To avoid problems, the capacitive door opening is deactivated for 3 seconds after closing the door.



When **Bob is disconnected from the power supply** you can still open the door but you will encounter **greater resistance** due to the deactivation of the door's capacitive opening system.

6 | CONFIGURE YOUR BASKET

Bob adapts to multiple types of dishes thanks to its modular design and can thus be used all sorts of occasions.

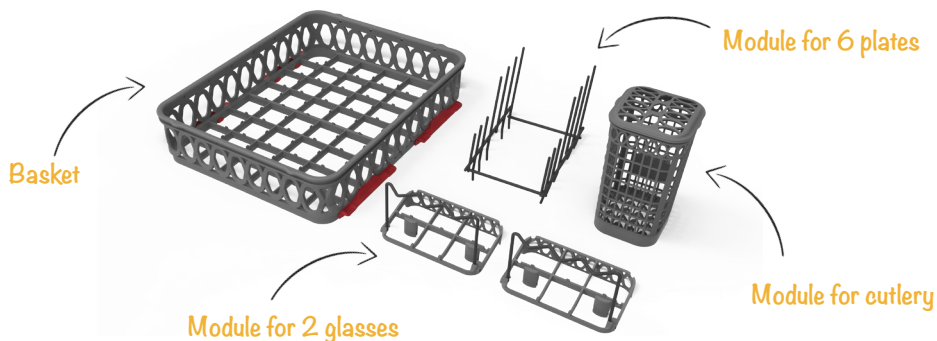

The basket allows you to place the module in many different ways.

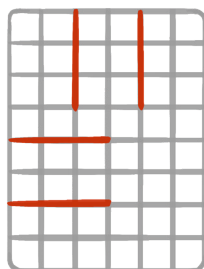

You can place the plate module either in the middle of the basket or at one of the two sides.

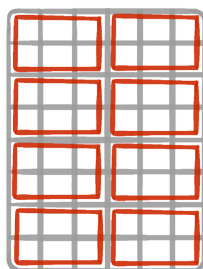

You can place up to **8 glass modules** in the basket with **Bob.extraglass!** (Optional)

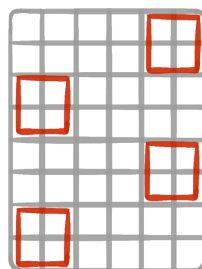

Choose where you want to place the cutlery module, or remove it if you do not need it!

Daan Tech offers **additional basket modules on its website.**

for further information on the possible uses of the basket and its modules, please refer to page 32.



Place your forks and knives so that the closing of the door is not disturbed. In fact, sharp elements can damage the seal and cause leaks.

7 | DISCOVERING THE Bob.cassette



Bob cassette is a starting requirement for Bob.

You must **always** have a Bob cassette **inserted** to start a program (even if empty).

Daan Tech offers **several types of Bob cassettes including washing and rinsing detergent tailored to Bob.**

pop cassette

For your dishes

30 cycles/cassette

= 1 month of use

(Based on a daily use)

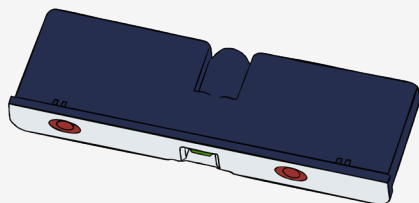

All-in-one

Rinsing liquid and salt included



Highly concentrated
perfectly clean even in
Express mode.

To learn more about the
pop cassette, please
refer to page 46.

rock'n'roll cassette

For Bob

1 maintenance cycle for Bob

= for a program that runs Bob empty to
clean the dishwasher itself (spray arm, pipes,
heating element)

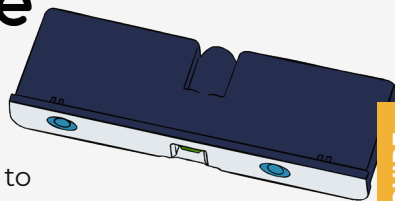

**The maintenance
program**
extends Bob's lifetime



**Removes oil and
grease.** Removes the
limescale

To learn more about the
rock'n'roll cassette,
please refer to page 64.

Installation of a Bob.cassette

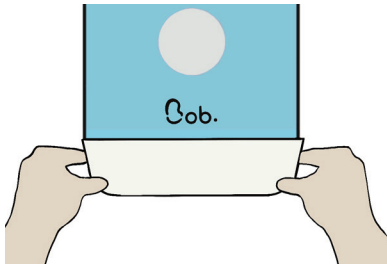

To use a Bob cassette, insert it into the tray located at the bottom of Bob's front.

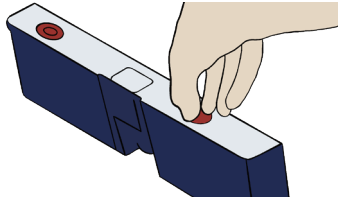

Warning: Please mind removing the plastic film and the two plastic caps before inserting the Bob cassette.

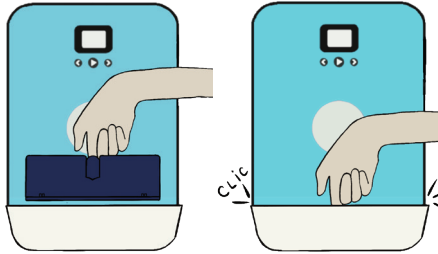

Push the cassette - in the insertion direction, so that the text at the top of the cassette is in the reading direction - into the tray until it clicks.



Our commitment with the DAAN POSITIVE CYCLE

Each time you run Bob instead of washing your dishes by hand, you consume 5 times less water. We have decided to go one step further and created the **Daan Positive Cycle**, a new system that enables reducing the disposable plastic waste.

Instead of using dishwasher detergent from disposable plastic bottles, we designed the Bob cassette to be reuseable!

Do not throw your Bob cassette away, but please return it to us free of charge. We will clean and refill it so that it can be reused.

With the Bob cassette we are trying to reduce our ecological footprint.

To learn more about our **Daan Positive Cycle** program, please visit: www.daan.tech/en/daan-positive-cycle

1

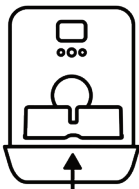

2



3



8 | BOB IS READY !!

Good news, you have completed the set-up of your Bob and inserted the Bob cassette. Now, it's time to launch a first fully-automatic cycle! Discover more.



QUICK UTILIZATION GUIDE

2

1 | INTERFACE

1.1 | Navigate through Bob OS interface

Bob has a 2.4" LCD display and 3 backlit buttons.

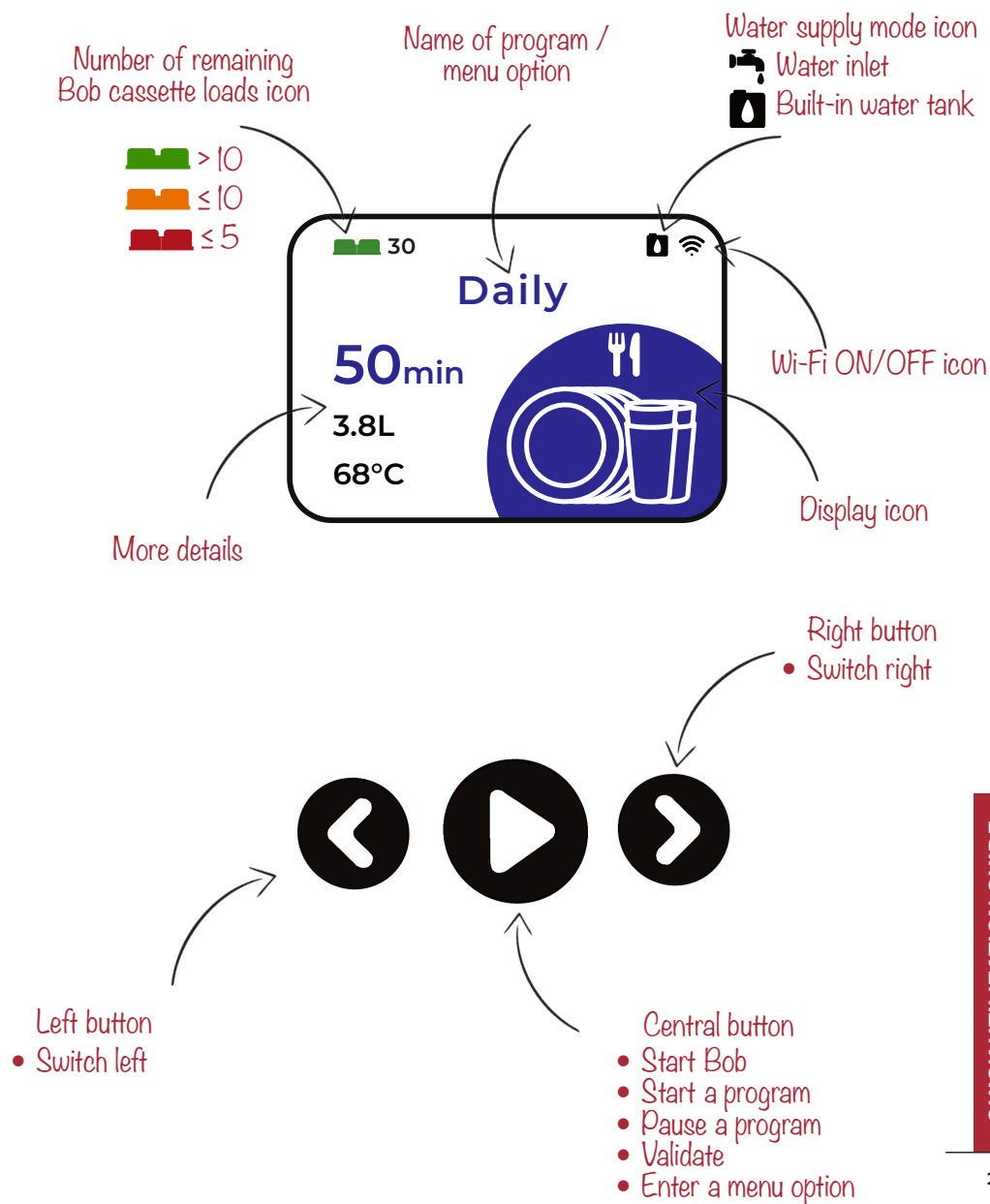

1.2 | Menu options of the home screen

When starting Bob you may navigate through the different menu options of the home screen.

You can navigate right and left by pressing ⏪ and ⏩.

The following menu options are available.

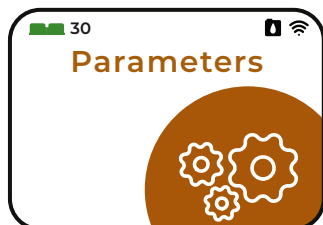

Parameters

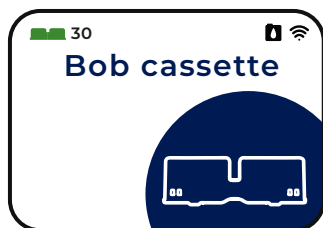

Bob cassette



Glasses

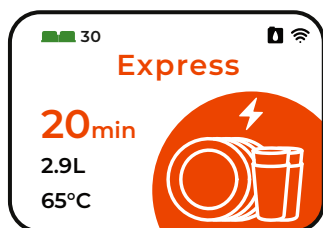

Express

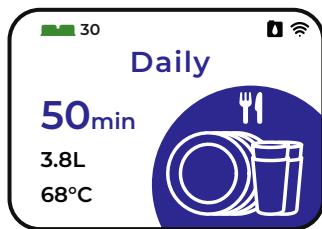

Daily

Factory reset start screen

You can change your start screen by selecting your preferred program in the “Setting” menu. The selected preferred program becomes your your new start screen.

For further information, please refer to page 24.

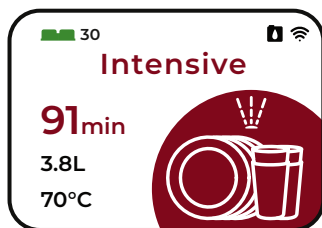

Intensive

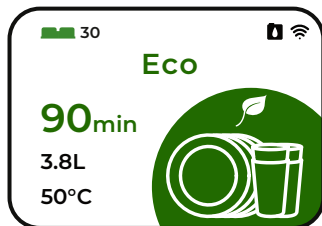

Eco



UVC sanitizer

Available only if you added the **Bob. ultraviolet** option during the purchase of your Bob. This screen allows you to run a UV-C cycle without any water to sanitize items with UV-C rays.

For further information, please refer to page 28.

Optional

1.3 | Settings



▶ Screen 1/14

This screen allows you to create a new cycle, including duration, temperature and a custom icon.

You can create up to 4 custom programs. To learn more, please either refer to page 44 or to our website.

Please scan the QR code to check it out on our website.

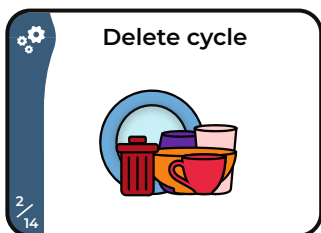

▶ Screen 2/14

This screen allows you to delete a cycle.



▶ Screen 3/14

This screen allows you to choose your favourite cycle as your start screen.

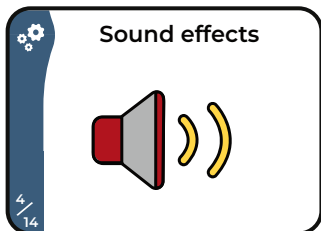

▶ Screen 4/14

This screen allows you to choose a custom sound effect (only available with Bob+)

To learn more, please refer to page 56.

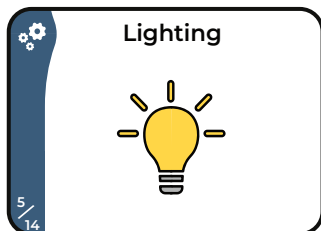

▶ Screen 5/14

This screen allows you to choose the degree of lighting (only available with Bob+)

To learn more, please refer to page 56.

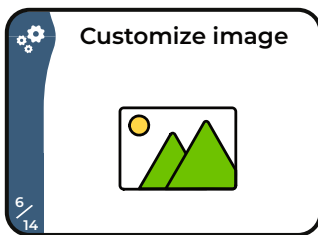

▶ Screen 6/14

This screen allows you to add a customized image when starting Bob or when Bob is running.

This feature is available only with Bob+. To learn more, please refer to page 55.

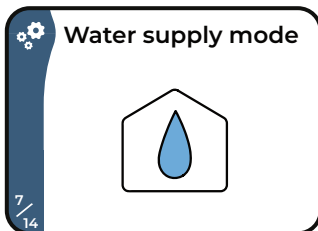

▶ Screen 7/14

This screen allows you to choose your water supply mode (water inlet or water tank). To learn more, please refer to page 5.

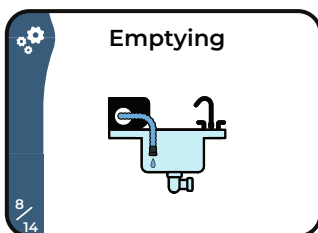

▶ Screen 8/14

This screen allows you to fully drain Bob (main interior, water tank and pipes).

Please always mind draining Bob when you do not use it for a long time or when the temperature is likely to go below 0°C.

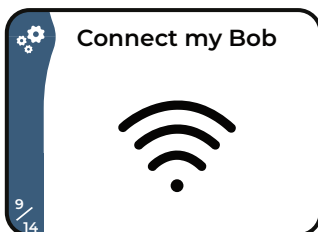

▶ Screen 9/14

This screen allows you to pair Bob with your Daan Tech account. To learn more, please refer to page 52.

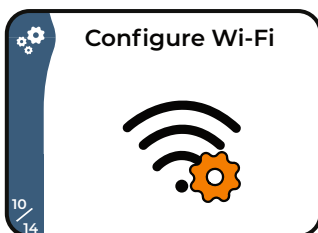

▶ Screen 10/14

This screen allows you to change the Wi-Fi settings. For instance, if you move to a new place or change your internet provider.

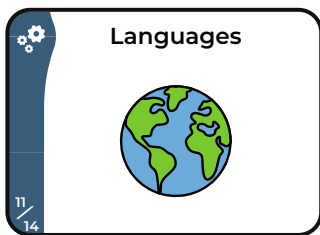

▶ Screen 11/14

This screen allows you to change the interface's language.

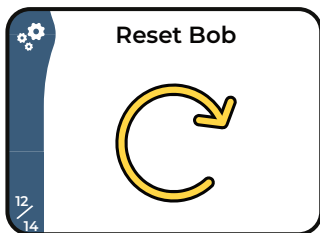

▶ Screen 12/14

This screen allows you to reset Bob to factory settings and delete all saved data.

Warning: deleting data cannot be undone.

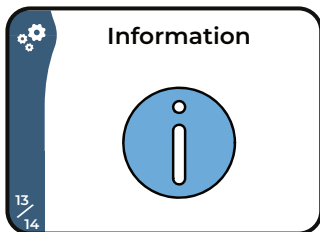

▶ Screen 13/14

Within this menu, you can:

- See how much water you have saved using Bob.
- Display the Bob OS version installed on your Bob: Bob OS. The MAC address of your device (required for pairing Bob with your Daan Tech account)
- Display a QR code for reading the latest user manual version in PDF format.

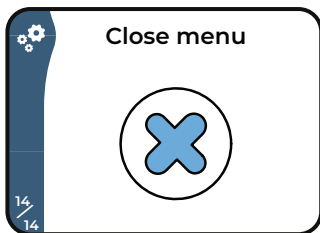

▶ Screen 14/14

This screen allows you to close the settings menu and go back to the home screen.

1.5 | Bob.cassette menu

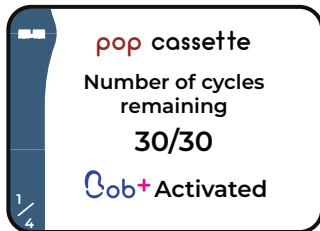

▶ Screen 1/4

This screen displays how many remaining loads are available in the pop cassette and also shows your Bob+ status.

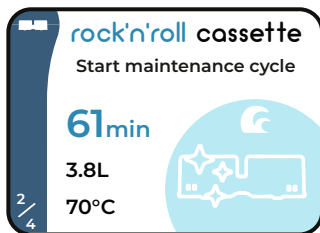

▶ Screen 2/4

This screen allows you to launch a maintenance program with a rock'n'roll cassette. To learn more, please refer to page 64.

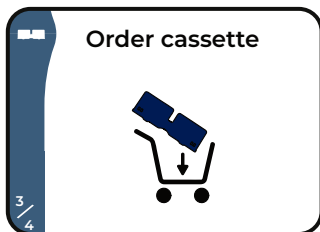

▶ Screen 3/4

This screen allows you to order a new Bob cassette. Several options are available:

- 1 pop cassette
- 1 rock'n'roll cassette
- 1 compilation pop/rock including 3 pop cassettes & 1 rock'n'roll cassette.

If your Bob is paired with your Daan Tech account, you can order a cassette in 1 click.

For more information, please refer to page 49.

If your Bob is not connected to Wi-Fi, you can scan the displayed QR code to order a new cassette directly on our website.

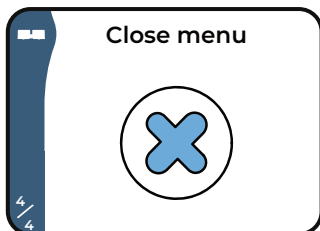

▶ Screen 4/4

This screen allows you to close the Bob cassette menu and go back to the home screen.

1.6 | Bob. ultraviolet program



Available only if you added the Bob. ultraviolet option during purchase.

How does it work?

Open the door and place objects to sanitize in the basket. Only the side exposed to UV-C will be sanitized. Run the program several times to ensure sanitizing the object from every side.

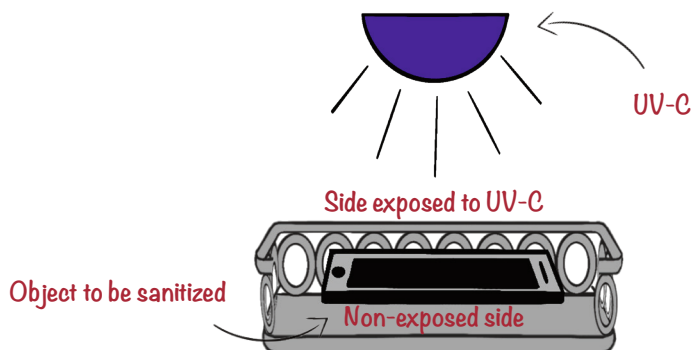

**You can choose between two durations for this program:
20 and 60 min.**

For safety concerns, Bob shuts the UV-C rays instantly down when you open the door. In addition, Bob's porthole is made of a plastic type that lets only visible light go through and blocks UV-C rays. The UV-C program ends with the opening of the door and a signal sound.

For further information on the UV-C sanitization mode, please visit our website.

Please scan the QR code to check it out.



Bob is not a medical device and is not intended to be used as such. Daan Tech shall not be liable for any consequence of improper use, such as using Bob instead of a sterilizer. Daan Tech does not provide warranty of any kind regarding the removal of micro-organisms and viruses on objects.

2 | BASKET SET-UP

2.1 | Maximum size of plates

**The dimensions of Bob's interior are the following:
29 cm (11,4 in) height / 28 cm (11 in) width /
35 cm (13,8 in) depth**

Even considering the small size, Bob fits many items of different dimensions and shapes.

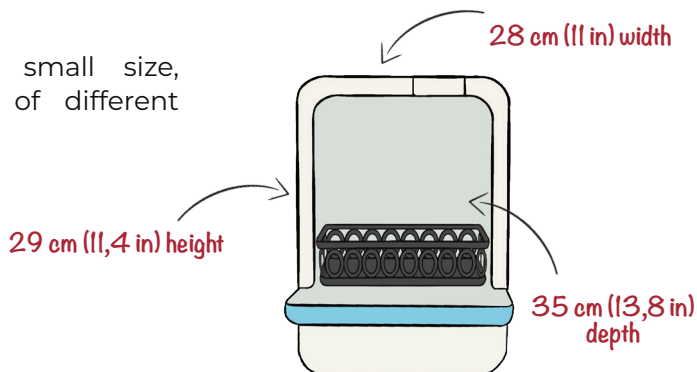

A few examples of items fitting in Bob

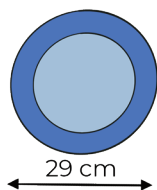

Plates of a diameter up to 29 cm (11,4 in).

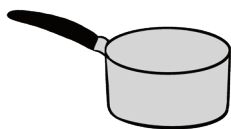

Pans or saucepans

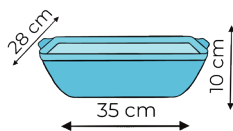

Platters, up to 35 cm (13,8 in) length x 28 cm (11 in) width x 10 cm (3,9 in) height



Baby bottles, carafes, and more.



Prefer using pans and saucepans with removable handles to save space.

2.2 | Recommendations on how to place kitchenware inside Bob

Bob's configurable basket matches all kinds of kitchenware.

Before putting kitchenware inside Bob, please **mind some recommendations**:

1. **Please remove food waste**, as it might block the filter or the spray arm.



2. **Soak (sauce)pans with hot water** if there are **burnt stains** before placing them in the basket.

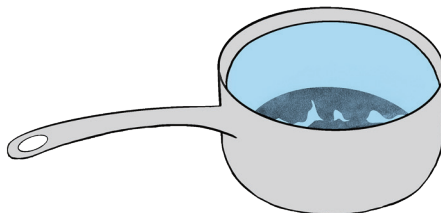

3. Please mind checking that your **kitchenware (in particular lightweight ones)** such as plastic containers **are fixed so that they do not flip or impede the spray arm while the program is running.**

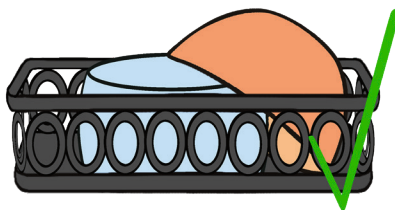

4. Please place **objects**, such as pans, cups and glasses etc., **in a way that they do not store liquid while the cycle is running.**

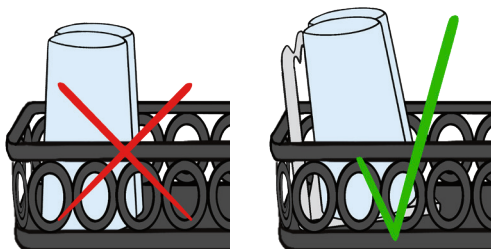

Some items shall not be cleaned using a dishwasher:

- Kitchenware items that are made from stuck or welded parts and do not withstand heat.
- Kitchenware items made of copper, tin, crystal, aluminium, zinc, or are likely to rust, wood, synthetic fibres or which cannot withstand heat.
- Kitchenware with handles made of wood, horn, porcelain or nacre.

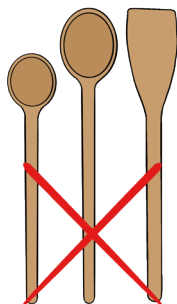

Very often, items that can be cleaned with a dishwasher have one of the following label on the packaging.



Knives and other kitchenware with long blades may cause hazard if they are not pointing downwards. **Thus, please make sure to load items in such a way that the blades pointing to the bottom.**

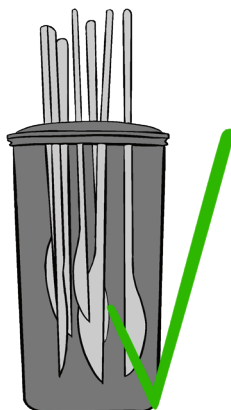

Warning: Never start a program without the main basket.

2.3 | Basket configuration according to your needs

Depending on your dishes, adapt the modules to ensure easy handling and guarantee optimal washing performance.

Here are a few examples of basket configurations using different modules, according to the time of day:



BREAKFAST (2 people)

- 2 small plates
- 2 bowls
- 2 knives
- 2 small spoons
- 1 big spoon
- 2 glasses
- 2 cups

Recommended cycle

Express - 20 min - 2,9L of water

Degree of soiling

Slightly soiled but no dried up or burnt-in fat, chocolate, lactose or theine

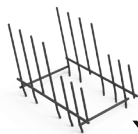

x1

Plate module



x2

Glass modules



x1

Cutlery module





LUNCH(1 person)

- 1 big plate
- 1 salad bowl
- 1 knife
- 1 fork
- 1 small spoon
- 1 glass
- 1 cup
- 1 cooking pot

Recommended cycle

Daily - 50 min - 3,8L of water

Degree of soiling

Soiled, but no dried up or burnt-in gluten, oil or fat



x1

Plate
module



x1

Glass
module



x1

Cutlery
module





AFTERNOON

(Cooking lesson)

- 1 salad bowl
- 2 bowls
- 1 whisk
- 4 big spoons
- 2 big knives

Recommended cycle

Express - 20 min - 2,9L of water

Degree of soiling

Soiled but not dried



x2

Glass
modules



x1

Cutlery
module





PREPARATION OF THE DINNER

(2 people)

- 2 bowls
- 1 cooking pot
- 1 pan
- 2 knives
- 2 big spoons

Recommended cycle

Daily - 50 min - 3,8L of water

Degree of soiling

Soiled but not dried-up / tomato sauce, gluten, etc...



Cutlery
module

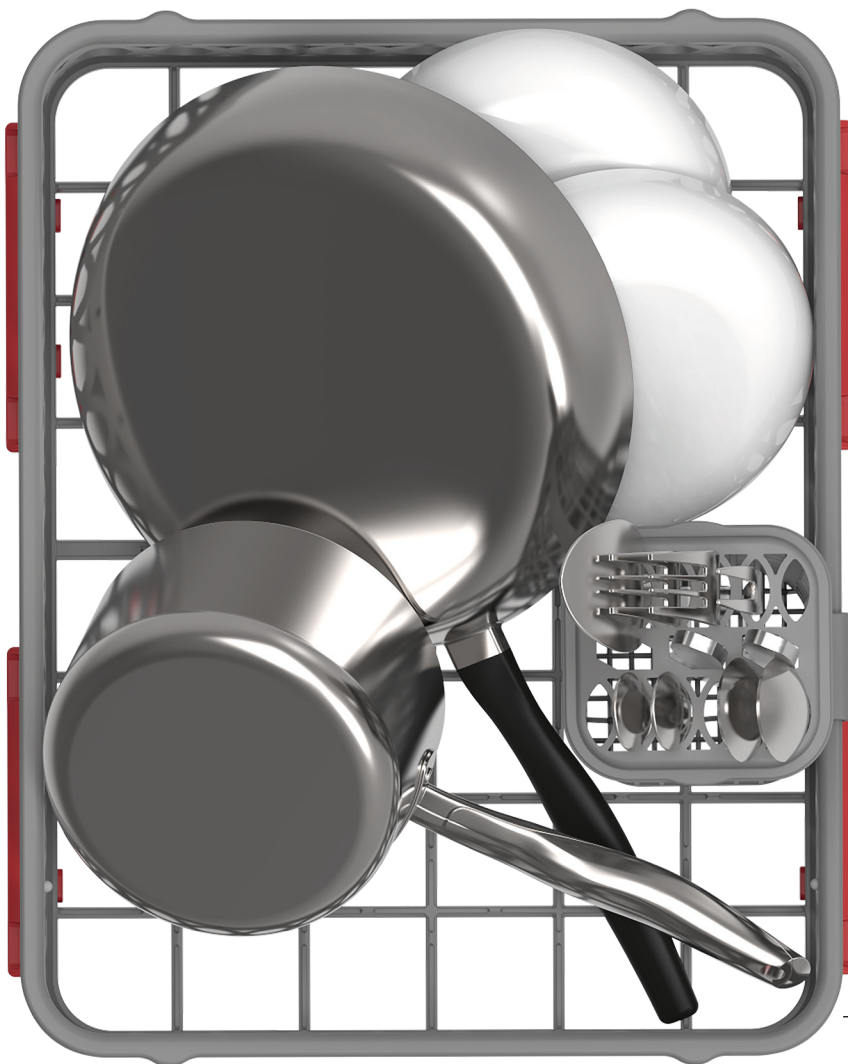



DINNER WITH GUESTS

(4 people)

- 4 big plates
- 4 knives
- 4 forks
- 4 small spoons
- 4 glasses
- 4 cups

Recommended cycle

Intensive - 90 min - 3,8L of water

Degree of soiling

Soiled and dried up / gluten, plant fibres, alcohol, etc...



Plate
module

x1



Glass
modules

x2



Cutlery
module

x1

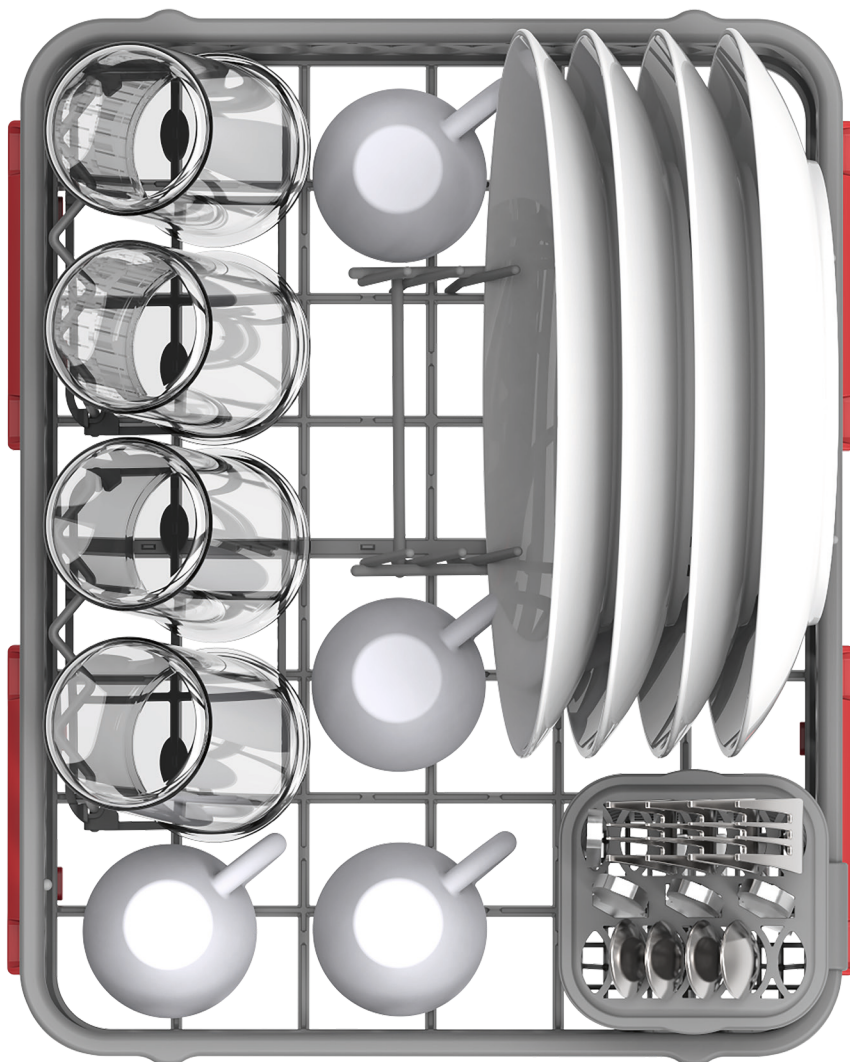



PARTY

- Between 12 and 16 glasses per cycle, depending on the diameter of the glasses.

Recommended cycle

Glasses - 15 min - 1,9L of water

Degree of soiling

Slightly soiled and not dried-up



x8

Glass
modules

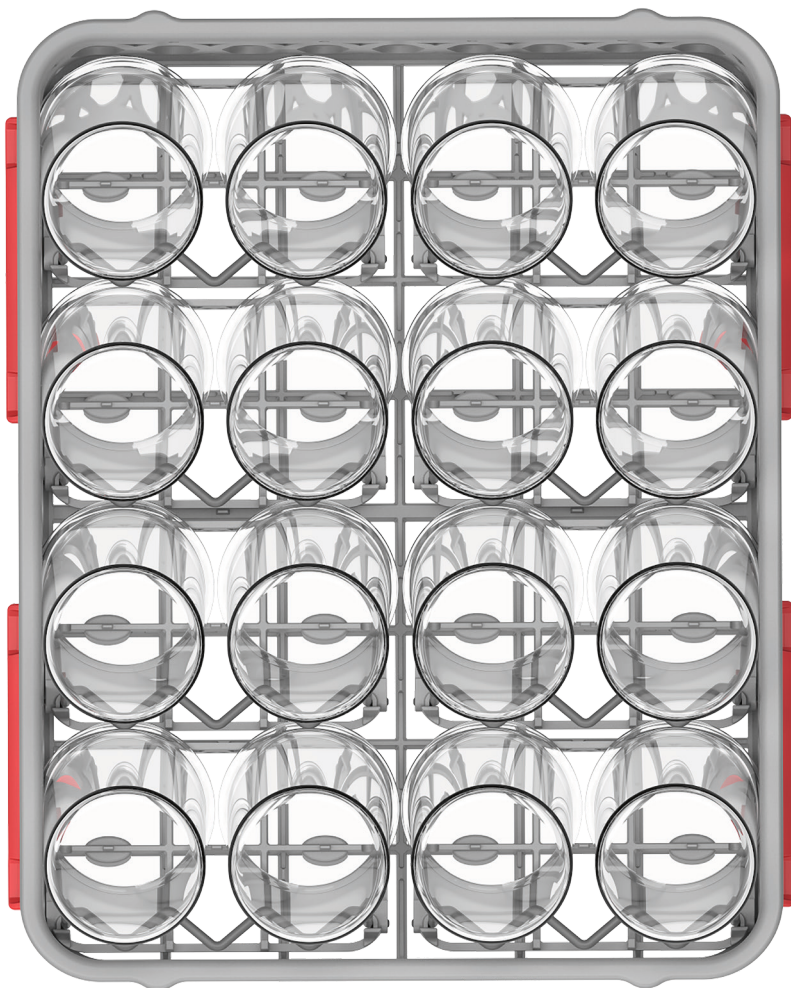

It's up to you! Compile the best fitting configuration(s) for your daily life! Further information about the configuration of the modules can be found on page 16.

Basket configuration according to European standards:

CYCLE FOR 2 STANDRAD PLACE SETTINGS

- 2 big plates ①
- 2 soup plates ②
- 2 dessert plates ③
- 2 glasses ④
- 2 cups ⑤
- 2 saucers ⑥
- 1 oval plates ⑦
- 1 baking dish ⑧
- 1 mid-sized bowl ⑨
- 2 knives ⑩
- 2 soup spoons ⑪
- 2 forks ⑫
- 2 dessert spoons ⑬
- 2 small spoons ⑭
- 2 serving spoons ⑮
- 1 serving forks ⑯
- 1 ladle ⑰

Recommended cycle

ECO - 90 min - 3,8L of water

Degree of soiling

Soiled and dried up / eggs, oat, milk, tea, margarine, spinach.

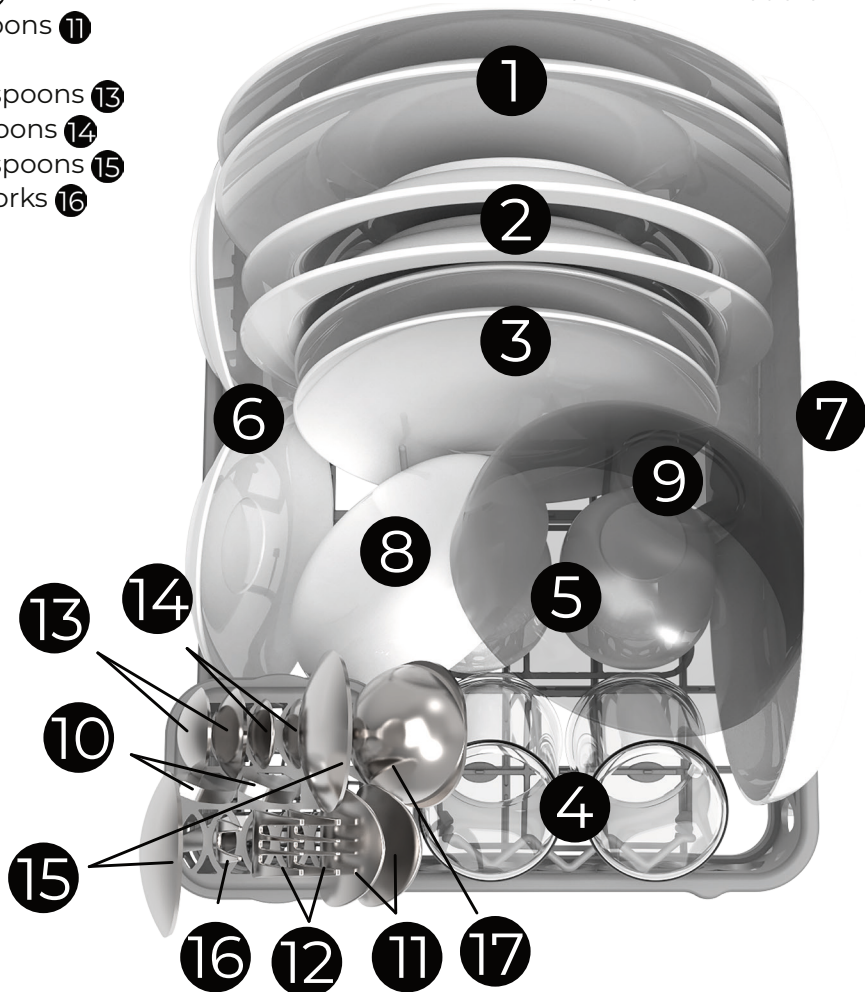
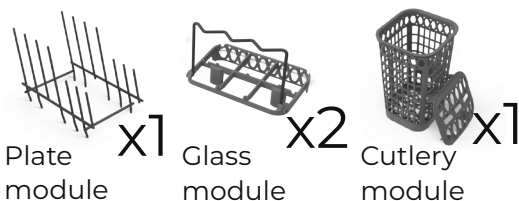

3 | WASH CYCLE

3.1 | How a wash cycle works

A wash cycle comprises several steps. You can follow the progress of the current wash cycle on Bob's home screen

You can see several information on the screen:

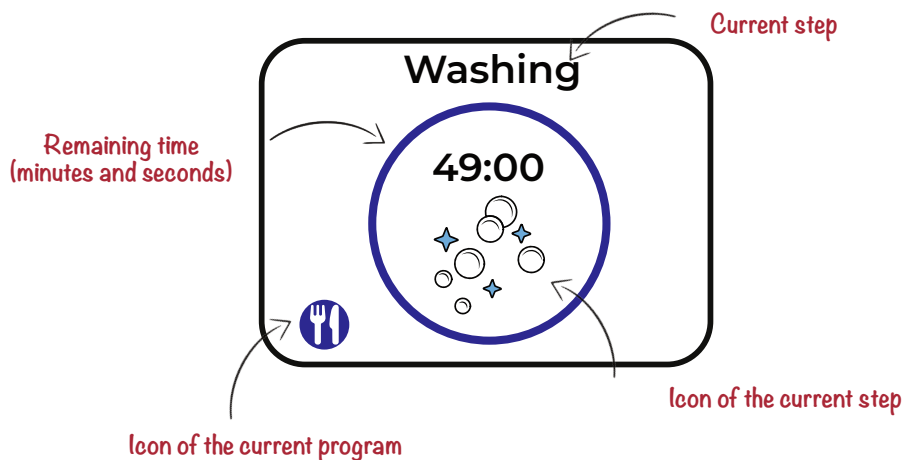

Before starting a wash cycle

- **Make sure that your dishes are positioned correctly in the basket**, as recommended on page 30.
- **Close the door.** Warning: the cycle cannot be initiated if the door is open or not properly closed
- **Check that a Bob cassette (even if empty)** is correctly inserted into the designated tray. This is Bob's start key, without which the cycle will not start.
- **Choose the most appropriate program** according to your dishes and the degree of soiling
- **Start the cycle** on Bob's colour display (see page 22).
- **Fill the water tank until the signal sound occurs** if your Bob is in the water supply mode "built-in water tank"

Emptying



Check on the drain hose



Warning: Ensure that the drain hose is correctly positioned at a water drain or a container during the entire cycle. Water is drained several times during a cycle.

Let's go! The cycle is running now!

During a wash cycle



Cancelling an ongoing cycle



Cycle on pause

Resume cycle?



- Press the central button  to pause the current cycle.
- Select  to abort the current cycle and to initiate a drain.
- You will automatically be redirected to the home screen.



Adding extra items during an ongoing cycle



Cycle on pause

Resume cycle?



- Press the central button  to pause the current cycle.
- Open the door and pay attention to the escaping hot steam
- Place the additional item in the basket
- Close the door
- Select  to continue the cycle



Warning: If you want to cancel a cycle or add additional items, you must press the central button to interrupt the program.

At the end of the wash cycle

Drying in progress

Wait for sound signal for cycle end



When the timer is close to zero, the “Drying in progress” screen is displayed.

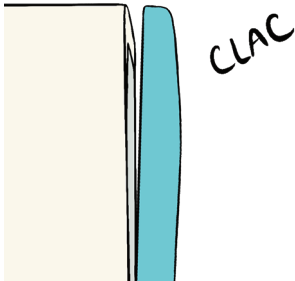

At this point, the door opens automatically and remains half-open with a 10 degree angle.



Warning Please note that hot steam is released when door opens

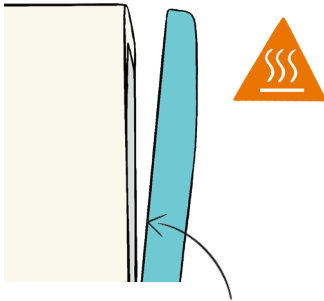

Depending on the program, drying might take several minutes and will not consume additional energy.

The program is not completed yet; please wait a few minutes for the drying to finish before removing your dishes.



Warning Please note that some items are very hot and could cause skin burns if removed too soon. Daan Tech shall not be responsible for such incidents, which occur when dishes are removed before the official end of the cycle.

Please note that some water residue may remain on your dishes if you do not wait for the drying to finish.





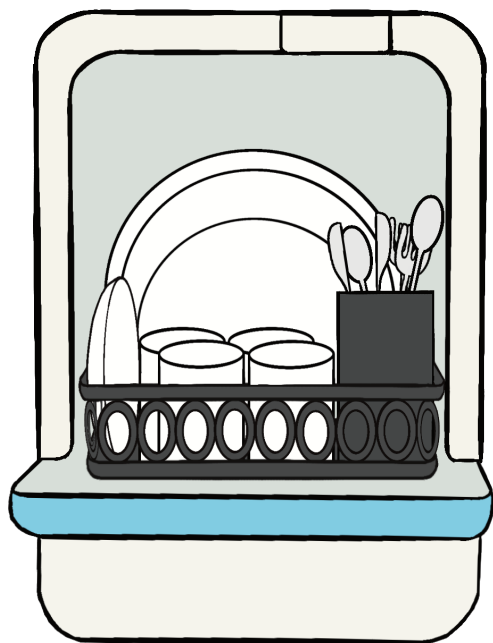

When the program is completed, a signal sound occurs (unless you have turned off the sound in “Settings”) and Bob will automatically go into standby mode.

Upon completion of the program, leave Bob’s door open (10°) to prevent unpleasant smell. This also reduces the energy consumption in the standby mode.

3.2 | Standard programs



Bob offers various programs dedicated to: specific occasions, different dishes and different degrees of soiling. Please consult the following overview to find out **which program is the best fit for your needs.**

CYCLE NAME					
					
Glasses	Express	Daily	Intensive	Eco	Maintenance
DURATION (MIN)*					
15 min	20 min	50 min	91 min	90 min	61 min
WATER CONSUMPTION (L)					
1.9 L	2.9 L	3.8 L	3.8 L	3.8 L	3.8 L
DEGREE OF SOILING					
**	**	***	*****	*****	
Glass and cup no dried-in stains.	Slightly soiled but no dried-in stains.	Soiled but not dried-in or burnt-in stains.	Soiled and dried-in and possibly burnt-in stains.	Soiled and dried-in but not burnt-in stains.	
EXAMPLES					
After a coffee break or a wine tasting	Breakfast	Lunch or dinner	(Sauce)pans, dishes and cutlery used for cooking	Lunch or dinner	Every 90 cycles
CYCLE STEPS AND TEMPERATURE (T°C)					
Washing at 65°C	Washing at 70°C	Pre-washing at 65°C	Pre-washing at 68°C	Washing at 60°C	Pre-washing 65°C
Cold rinsing	Cold rinsing			Cold rinsing	Washing 50°C
Hot rinsing at 65°C	Hot rinsing at 65°C	Washing at 40°C	Washing at 40°C	Hot rinsing at 60°C	First hot rinsing at 50°C
Drying at 70°C	Drying at 65°C	Cold rinsing	Cold rinsing	Drying at 60°C	Second hot rinsing at 65°C
		Hot rinsing at 65°C	Hot rinsing at 65°C		Drying at 72°C
		Drying at 65°C	Drying at 70°C		
ENERGY CONSUMPTION (kWh)					
0,23 kWh	0,26 kWh	0,35 kWh	0,48 kWh	0,35 kWh	0,41 kWh

*(Drying time not included)

3.3 | Creating and deleting a custom program

Bob allows you to create your own program to adapt to your personal needs and to optimise the washing of your dishes.

Before creating your own program:

When **creating your own program**, you have different options to **fine-tune 3 parameters**:

- The program duration (not including drying)
- The maximum temperature during the program
- The icon for your custom progra

For instance, you can create a custom program at 60°C for special dishes.

If you have particularly fragile dishes, you should prefer a longer duration of about 90 minutes but a lower temperature (e.g. 50°C)

If 20 minutes does not seem sufficient for you, you might add some additional time.

It's up to you to create the most adapted program for your dishes!



You can **create up to 4 custom programs** Once the limit is reached, you must delete a program (on the screen Settings > Delete cycle) to create a new one.

Daan Tech does not commit to the washing performance of a custom program.

Rename a custom program

If Bob is connected to Wi-Fi and paired to your Daan Tech account, you can change the name of your custom programs from the “Manage my Bob” tab.

How to create a custom program?

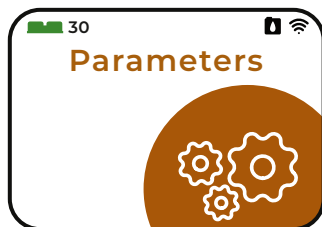

- Go to “Settings” and choose “Create new cycle”

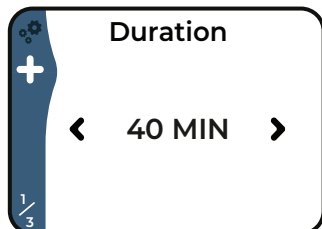

- Use the buttons ⏪ and ⏩ to choose a duration from 10 to 120 minutes.
- Confirm your choice by pressing the central button.

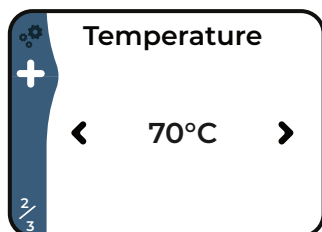

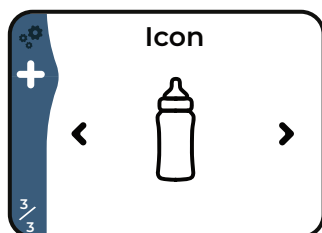

- Use the buttons ⏪ and ⏩ to choose the temperature from 30°C to 70°C
- Confirm your choice by pressing the central button.

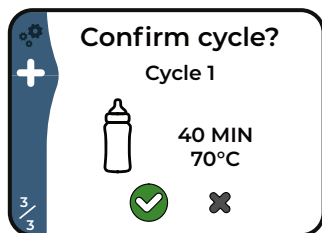

- Use the buttons ⏪ and ⏩ to choose an icon for your program.
- Take your time, you have 12 icons to choose from!
- Confirm your choice by pressing the central button.



- Once those 3 parameters are defined, you will be asked to confirm your custom program.
- Select  to save your custom program.
- Select  to cancel the custom program and be redirected to the “Create a cycle” screen.



In case of an incorrect entry: **unfortunately, it is not possible to go back if you have selected a parameter you did not want to.** Thus, you must continue with the remaining steps and cancel it on the final release screen . You can then start to create custom program again.

4 | Bob.cassette AND THE DISTRIBUTION OF DETERGENTS

The concept

To ensure the best washing performance, it **is mandatory to use washing and rinsing detergents.**

Several products must be used:



- A **dedicated product** during the **washing step** to **remove soil and clean the dishes**
- A **dedicated product** during the **rinsing step** to **remove limescale on glasses, for instance.**



Please only use dishwasher detergents. Using other detergents, such as hand soap may damage the product and end the warranty. **Please note that dishwasher detergent are corrosive and dangerous. Keep them out of reach of children.**



During Bob's development, Daan Tech benchmarked existing solutions:



Using all-in-one dishwasher detergent:

The rinsing product is absorbed after the washing step, and thus rinsing occurs without rinsing detergent.

Results:

- Limescale may appear (especially on glasses)
- Accumulation of limescale after several cycles that damages the dishwasher.
- Disposable plastic bottle for single use.

Using dishwasher tabs:

Dishwasher tabs are designed to dissolve at different speeds, thus cannot develop their full potential in a short cycle.

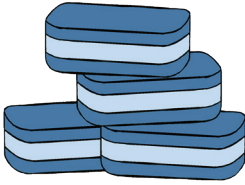

Results:

- Rather poor washing performance
- A part of the tab remains at the bottom of the interior at the end of the cycle.
- Plastic microspheres, which separate the different chemicals present in a tab, lead to greater water pollution and could also remain on dishes.

Using dishwasher powder:

A dose of powder must be added before each cycle. Thus, you might sometimes forget it.

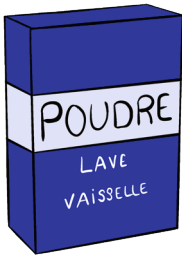

Results:

- Difficult to add the right quantity; very often more than needed.
- If you forget to add it, your dishes will not be cleaned properly.

Consequently, Daan Tech concluded that none of the existing solutions appear truly satisfactory. Therefore, to simplify Bob's handling, **Daan Tech has developed the Bob cassette: the world's most efficient dispensing system for dishwasher detergent. It replaces all the conventional dishwasher products** and makes it possible to control the injection of various detergents and rinsing products during the cycle.

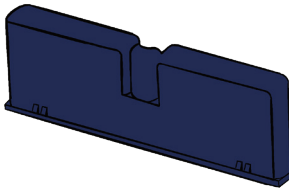

If you do not use Bob cassette, you must add conventional dishwasher detergent directly into Bob's main body before starting a program.

Warning: Do not put detergent tabs, liquids, powder or anything else in the Bob cassette tray.



Conventional dishwashers have a regenerating salt tank for anti-calcifying the water, which must continuously monitored and frequently refilled.

Bob does not require any dishwasher salt as everything is contained in the cassette! The limescale is automatically removed with the "rock'n'roll" cassette solution.

Characteristics of Bob cassette.

The right amount of detergent at the right time.

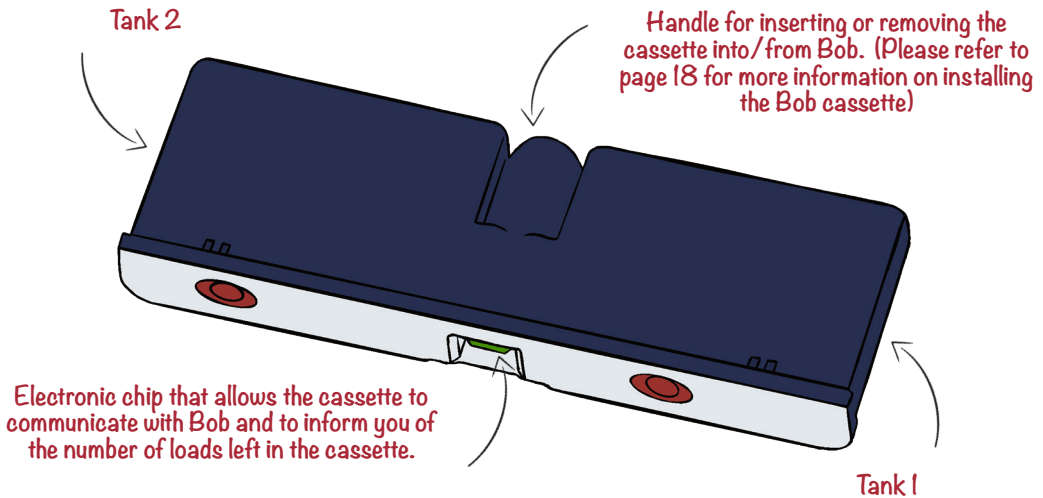

Which are the benefits of Bob cassette?

- Very simple!
- You do not need to buy any special dishwasher salt or detergent, as everything that you need is included in the Bob cassette.
- Everything is injected automatically ensuring the best possible washing performance.
- Reducing the quantity of detergent used: only the required quantity is injected.
- Reducing packaging and single use plastic + less detergent used = less waste and pollution
- Made in our factory in France from recycled and recyclable plastics.

DAAN POSITIVE CYCLE : Reusable flasks to fight the consumption of the single use plastic.

Where to buy Bob Cassette?

There are 3 ways to buy a new Bob cassette:

1 Directly on our website www.daan.tech

Log on to our website with any device (smartphone, computer, etc.), add one or several Bob cassette to your shopping cart, complete your order and receive it at your place.

2 One-click order directly on your Bob

Even more convenient and accessible if your Bob is connected to Wi-Fi and paired to your Daan Tech account (for more details on how to pair Bob, please refer to page 58)

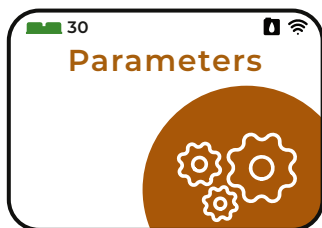

Within the "Settings" menu go to the Bob cassette screen.

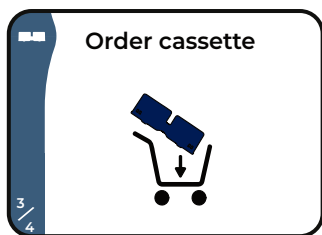

Navigate to the "Order cassette" screen.



Choose the type of Bob cassette you want and confirm with the central button.

 You will **receive your order to the registered address** in your Daan Tech account.

3 If you subscribed to Bob+, you will never run out of Bob cassette!

A new Bob cassette will be sent as soon as your current one is almost empty. For more information, please refer to page 54.



Warning: Since the products used in the Bob cassette are corrosive and require precaution, you cannot refill it yourself. To ensure a continuous running of Bob, you must order a new cassette before sending the old one back to Daan Tech. Otherwise, you cannot start a program. As an inserted Bob cassette (even if empty) is a starting requirement for using Bob!

Technical details and the composition of Bob cassette

pop cassette

For your dishes: 30 cycles / pop cassette

A solution specifically developed for Bob, the mini dishwasher.

Tank 1 Washing detergent (Contains 130ml/ 30 loads)

Efficient even in Express program.
Concentrated formula for soft to hard water,
EDTA-free, phosphate-free, chlorine-free.
Contains mineral salts, strong chelators and
dispersing agents: cutting through grease
and removing soil. (SODIUM HYDROXINE and
ETIDRONIC ACID) Food contact (decision of
08/09/1999 modified on 19/12/2013)

UFI: 9AD7-407V-T002-OTTS.

Composition : Less than 5% made of
phosphonates and polycarboxylates

Tank 2: Rinsing liquid and detergent with enzymes (contains 35ml / 30 loads)

Rinsing liquid and salt included. Shines,
removes grease residues, cleans and refreshes.

Composition : Less than 5% made of non-
ionic surfactants, polycarbonate, enzymes,
benzisothiazolinone and perfumes

rock'n'roll cassette

ONLY FOR BOB (without dishes): 1 cycle / rock'n'roll cassette

A solution specifically developed for Bob the mini dishwasher.

Tank 1: Cleaning agent for Bob (contains 130ml/1 load)

Highly concentrated formula that deeply
cleanses your Bob and removes lime scale to
prevent damage and extend the life of
your Bob.

UFI: P7D7-M0JG-G00K-AG7Q

Composition : SODIUM HYDROXIDE
and ETIDRONIC ACID.

Less than 5% made of phosphonate et
polycarboxylates.

Tank 2: Maintenance agent for Bob (contains 35ml/1 load)

Maintenance function for tubes, hoses and
pumps

UFI: CM57-N0DW-W00G-D6CR

Composition : METHANE-SULFONIC ACID

Contains: EC 215-185-5 SODIUM HYDROXIDE. Causes severe skin burns and eye damage.
Keep out of reach of children. If swallowed, rinse mouth, do not induce vomiting. In
case of skin contact: Remove all contaminated clothing immediately. Rinse skin with
water for several minutes. In case of contact with eyes: Rinse thoroughly with water for
several minutes. Remove contact lenses, if present and easily removable, then rinse
further. Call a TOXIC INFORMATION CENTRE or doctor immediately. Keep flask or label
available.



Bob's unique ID numbers

- **A unique birth number created during the manufacturing process!** You can find this number on the **label on the backside of Bob**, in the form of “Bob #0000000”

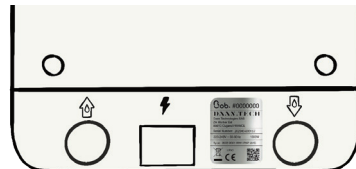

- **A unique software ID that allows you to link Bob to your Daan Tech account.** You can find the **software ID** (or MAC address) of your Bob **when you connect Bob to Wi-Fi or in “Settings” > “Informations”**. Format 00:00:00:00:00:00

Bob ID:
00:00:00:00:00:00

Login to your account on www.daan.tech and enter this ID in the "Manage my Bob" tab

How to manage Bob from your account?

Every Bob ordered on www.daan.tech is linked to a customer account. Once you ordered Bob, you can see its profile directly on the dashboard in your “My Account” area.

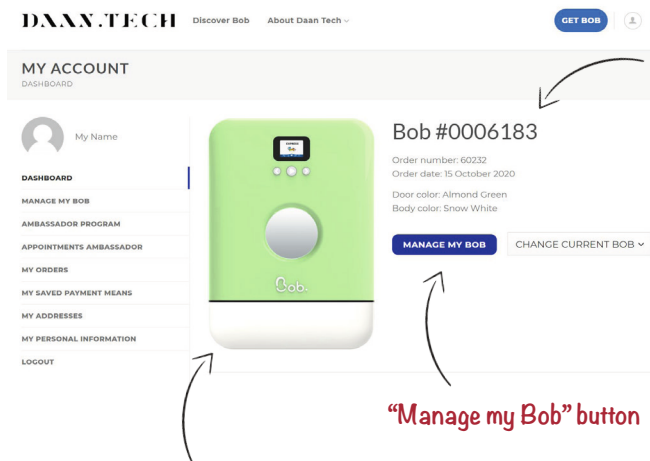

Unique number of your Bob

“Select another Bob”
button

“Manage my Bob” button

Miniature of your Bob with its colour



If you have ordered several Bobs with the same Daan Tech customer account, you can switch from one Bob to the next using the drop-down menu “Select another Bob” **Warning: Each option or service must be activated separately and independently for each Bob.**

Transferring the ownership of your Bob (gifts, sale)

Every Bob is linked to a natural person. If you have **ordered a Bob for a relative or friend or if you would like to sell it, you must transfer the ownership to the customer account of the future owner.**

To do so you need to follow these steps:

- Within the Daan Tech customer area, go to **“Manage my Bob”**
- **Select the Bob you want to transfer** using the drop-down menu “Select another Bob”
- Now click on the **“Transfer my Bob”** button at the bottom of the page.
- A new window opens
- **Enter the email adresse of the future owner** in the dedicated field (Note : **the future owner must have a user account on www.daan.tech**)
- Enter the text **transfer-my-bob** to confirm the transfer and then validate the option.

A confirmation email will be sent to both you and the new owner.

Connecting Bob to Wi-Fi and pairing it with your Daan Tech account

Bob can be connected to Wi-Fi and paired with your Daan Tech account thanks to its MAC address (for more information, please refer to page 51).

If you Bob is not connected yet, connect by going to “Settings” > “Connect my Bob”. For more information, please refer to page 12 of the Quick Set-Up Guide.

Once your Bob is paired with your account, you can activate Bob+.

Benefits of Bob+

Ready for a Bob that takes care of everything itself?

Bob+ is a free of charge of and non-binding service that adds new features to your Bob.

Bob.	Bob+	Software functionalities
✓	✓	5 standard cycles (Express, Daily, Intensive, Glasses and Eco)
✓	✓	Creating a custom program(page 44)
✓	✓	Rename the custom program (page 44)
✓	✓	Choice of a favourite cycle
✓	✓	Wi-Fi Connection (pages 12 and 52)
✓	✓	Choice of language (6 available languages)
✓	✓	Choice of water supply mode
✓	✓	Order a new Bob cassette in one click on Bob (page 49)
✓	✓	Choice of sound volume (mute, medium and loud)
✗	✓	Choice of the signal tone (at start and end of cycle) (page 56)
✗	✓	Choice of lighting (page 56)
✗	✓	A custom image can be added when starting Bob (page 55)
✗	✓	Automatic renewal of your Bob cassette (page 54)

Automatic renewal of your Bob.cassette

You will receive your cassette according to your needs rather than receiving a cassette on a regular basis

- Bob+ monitors the remaining loads and can therefore anticipate a low level load status of your current cassette
- Before your cassette is empty, an order is automatically placed via Bob+ in connection with your Daan Tech account.
- You will find your orders for the cassette and the corresponding invoices in your My account > My orders section on www.daan.tech

Choose the offer that suits you

Cassette by cassette

You will receive a new pop cassette when your current one is almost empty. Sent individually and adapted according to your needs.



30 loads = 30 runs

pop cassette

Compilation of 3+1 cassettes

Economic package offer: You will receive a compilation package with 3 pop cassettes and 1 rock'n'roll cassette.

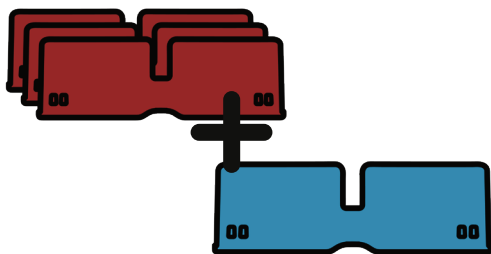

90 loads = 90 runs

+ 1 load for maintenance program

compilation pop/rock

Your order will be delivered directly to your home. Simply replace your current cassette, when it is completely empty, with the new, full cassette.

Adding a custom image when starting Bob

With Bob+ you can select custom image that will be displayed when you start your Bob

On the Daan Tech website (“My Account”)

- **Log in to your Daan Tech account** using your smartphone or computer.
- Click on **“Manage my Bob”**
- **Click the “Custom image” button**, then click the **button “Browse”** and then **Select the image** you want to upload to your Bob.



Accepted formats: JPEG. The recommended resolution is 320 x 240 pixels. There is no limit to the resolution and size of the file, but the image is processed by our servers after uploading to be optimised for the Bob display.

On Bob's display

- **Once the image has been uploaded to your Daan Tech account, you should restart your Bob (unplug the power plug and plug it in again)**

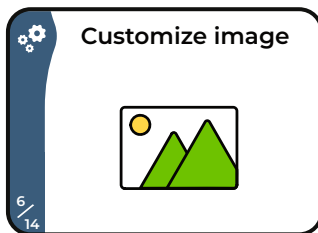

- Navigate to the **Settings menu and then “Customize image”**
- A preview of your image is available on the first screen.
- Navigate to the “Display mode” menu
- 3 options are available:

1. Do not display your image
2. Display the image only when Bob starts.
3. Display the both when Bob starts, as well as during the washing cycle.

Selection of the signal sound and sound effects (at the beginning and end of the cycle)

With Bob+ you can select the signal tones of your Bob:

- At the start
- At the end of a cycle

On the Daan Tech Website ("My Account")

- **On the page "Manage my Bob"** within your Daan Tech account, **you can view the list of available signal sounds.**



Modifications to signal sounds and sound effects can only be made directly on Bob's user interface.

On Bob's display

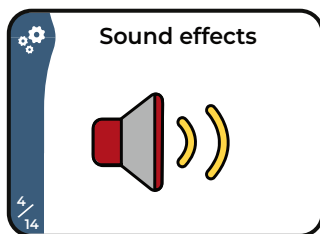

- Navigate to the **Settings menu and then to "Sound effects"** to access this feature.



Even without Bob+, you can still change the volume between: Mute, medium and loud

Choice of lighting

Bob+ allows you to select the lighting inside your Bob:

White (basic), blue, green , cyan, red, magenta, yellow, no lighting (LEDs off).

On Bob's display

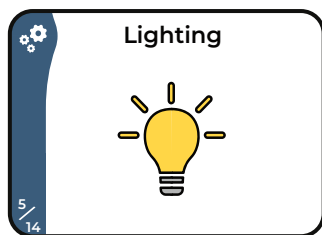

- Navigate to the **Settings menu and then "Lighting"** to access this feature.

How to activate Bob+?

The activation of Bob+ can only be done via your Daan Tech account in “My Account” on www.daan.tech

To activate Bob+, you have to follow the first 3 steps on your dashboard.

The screenshot shows the 'MY ACCOUNT' dashboard on the Daan Tech website. The top navigation bar includes 'DAAN.TECH', 'Discover Bob', 'About Daan Tech', and a 'GET BOB' button. The 'MY ACCOUNT' section features a user profile, a list of account management options on the left, and a central area for Bob+ details. The Bob+ details include a green Bob device image, the ID 'Bob #0006183', order information, and color specifications. Below this is a 'My account status' section with a progress bar at 25%. Four steps are listed: 'DELIVERY ADDRESS' (completed), 'PAYMENT MEAN' (no default provided), 'CONNECT BOB TO YOUR ACCOUNT' (not connected), and 'BOB+' (disabled). Red arrows and text annotations highlight the first three steps as required for activation.

Step 1: Fill in a delivery address

Step 2: Register a payment card
(A fictive payment of 1€ is required for the registration of a new means of payment, but this will not be debited from your account)

Step 3: Connect your Bob to Wi-Fi

Finally, you can activate Bob+ from the “Manage my Bob” tab.

You will receive a confirmation email confirming the activation of your Bob+ subscription.

The Bob+ service is not binding and you can deactivate it at any time at the bottom of the “Manage my Bob” page.

QUICK MAINTENANCE GUIDE

3

PRODUCT DESCRIPTION

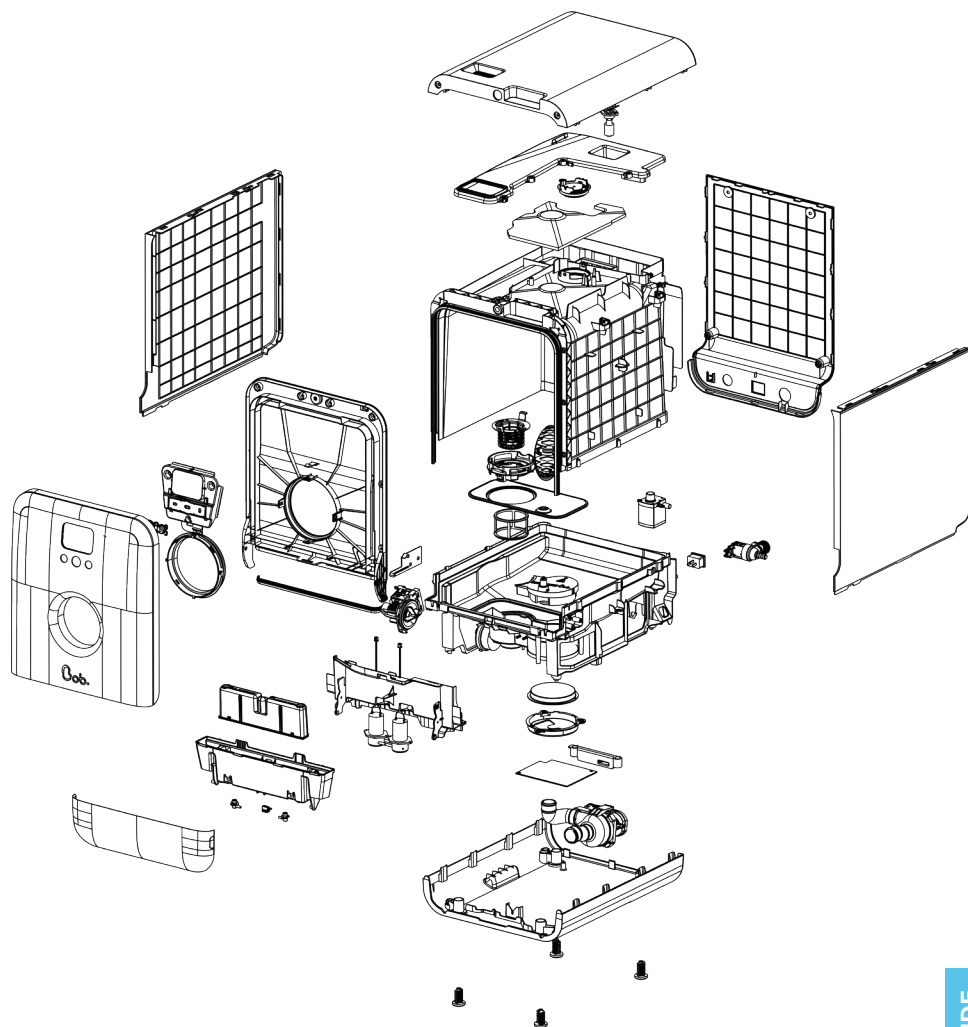

Bob is designed to last at least 10 as long as it is regularly and rigorously maintained.

To ensure a long life for Bob, please follow the recommendations found in this maintenance guide.

If you encounter a problem and need help please refer to page 73.

Maintenance calendar

Tasks	Timing	Tools
Filters	After each cycle	Water
	Once a week or every 10 cycles	Water Soft bristle brush
Heating elements	Once per month or every 30 cycles	Non abrasive sponge and degreasing product
Tubes and inner tank	Every 3 months or 90 cycles	Use a Bob rock'n'roll cassette to thoroughly clean your Bob. For further information please refer to page 64.
Plastic shell, screen and button	Depending on the amount of soil on Bob.	Moist wipe



Always unplug the appliance before cleaning.

1 | FILTERS

Bob's filter system, designed by Daan Tech, consists of 3 filtration stages

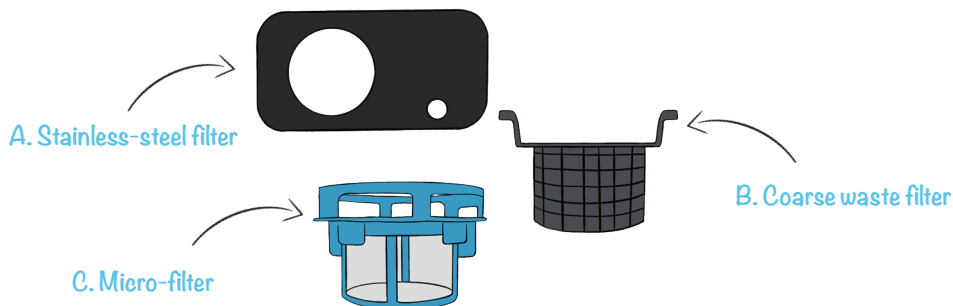

A. Stainless-steel filter: First filtration of soil and food particles through a perforated stainless steel mesh. This first filtration stage allows the water to pass through, while redirecting the soil to the second filtration stage.

B. Filter for coarse waste: Second filtration and recovery of coarse waste. Large lumps of food are collected in this coarse waste filter.

C. Micro-filter: Third filtration stage and filtration of fine particles thanks to a 120 micron microfilter.

Filter maintenance

After each cycle

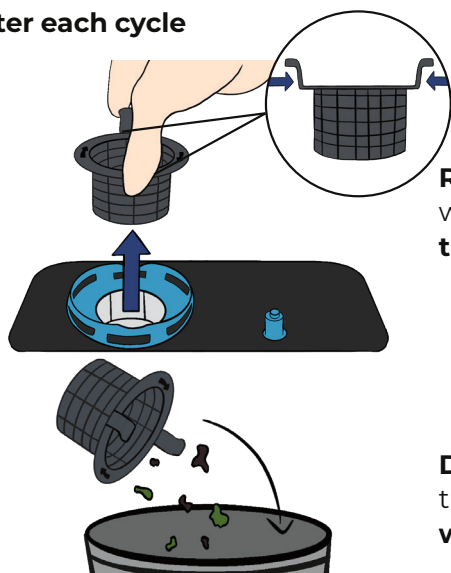

Remove the coarse waste filter with one hand using **its two grip tabs**.

Dispose the waste in the bin, clean the coarse waste filter **with clear water** and **put it back in place**.

Once a week or every 10 cycles

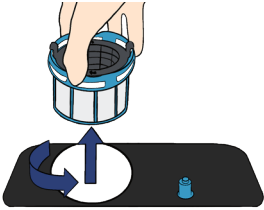

Turn the microfilter counter-clockwise to unlock the microfilter/coarse filter combination.

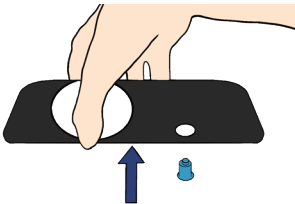

Additionally, lift out the stainless steel filter.



Rinse the 3 filters under running tap water and clean them with a soft bristle brush

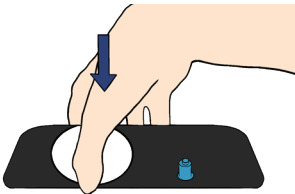

Put the stainless steel filter back into Bob.

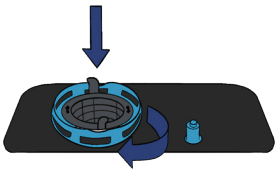

Now reinsert the micro filter/coarse waste filter combination by turning it **clockwise** until it **clicks** to ensure its correct position.



Warning: Never start a cycle without the filters in place.
If your microfilter is damaged, please contact Daan Tech service (page 73).

2 | HEATING ELEMENTS

The heating disk must be cleaned thoroughly to avoid clogging and reduced rinsing performance.

Once per month or every 30 cycles

To access the heating disc, **please remove the 3 filters**(see page 62).

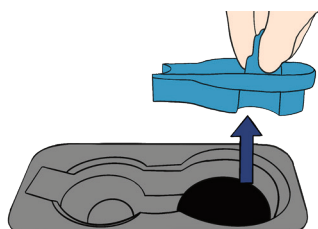

Then remove the protection part of the heating disc and clean it.



You then have access to the heating disc, **clean it with a non-abrasive sponge in order to avoid damaging (scratching) the non-stick coating.**

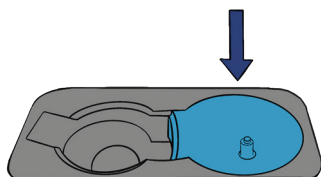

Put the protection part back in place.

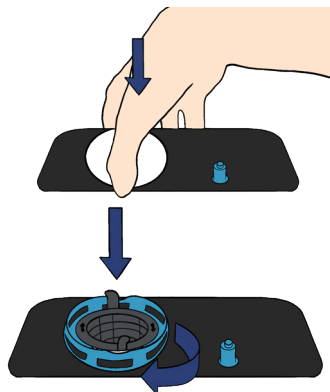

Then reinsert the 3 filters.

3 | TUBES

Once every 3 months or 90 cycles

rock'n'roll cassette

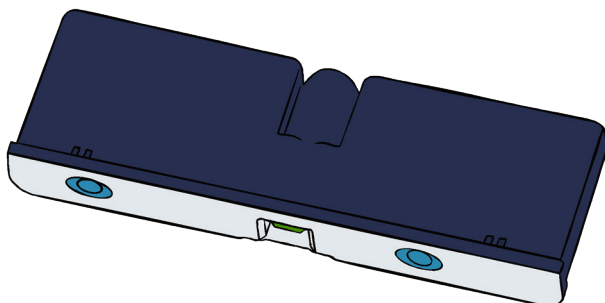
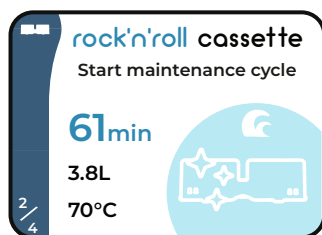

Cycle without dishes
Clean and refreshes
your Bob



**Decalcifies and
degreases** Removes
limescale deposits



Reusable cassette
Eco-friendly solution

How does it work?

1. Remove all the dishes from Bob and only leave the filters and the main basket inside.
2. Insert the rock'n'roll cassette into your Bob
3. Go to the Bob cassette screen and navigate to the rock'n'roll cassette (maintenance cycle) and then press  to start the cycle
4. The cycle takes about 60 minutes and cleans your Bob thoroughly: pumps, hoses, basket...
5. Each rock'n'roll cassette is intended for one-time use (all the contents are used up during 1 maintenance cycle)
6. Once the rock'n'roll cassette is empty, you can return it to Daan Tech to avoid throwing it away. We take care of the refilling.

Using a rock'n'roll cassette every 90 cycles keeps your Bob good shape!

4 | COVER AND SCREEN

Depending on the amount of soil on your Bob.

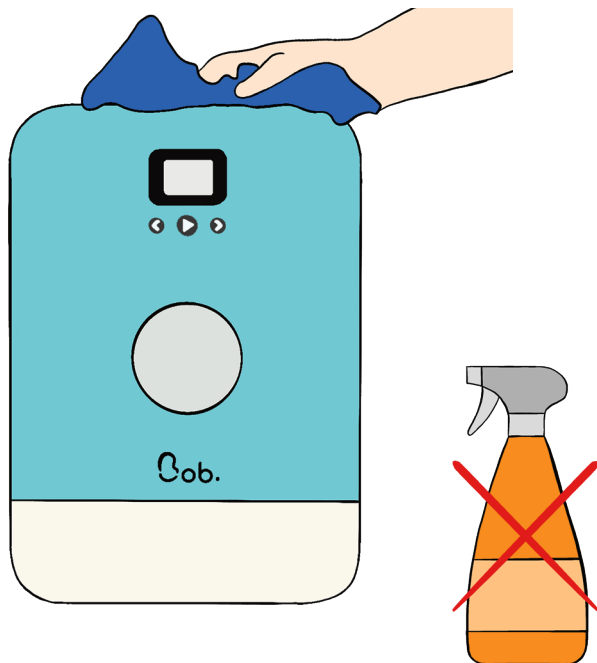

To **clean the exterior** of Bob, simply wipe it with a **damp cloth**



Please do not use any scouring agents, chemical solvents or strong detergents as this could damage the coating of Bob.

To prevent water from getting into the electronic components, screen, buttons or door lock system, **do not use a cleaning spray.**

5 | SPRAY ARM

If you encounter problems with the spray arm and have observed that it no longer turns, it may be a nozzle blockage that prevents it from turning. In this case, please follow the instructions below to clean the spray arm.

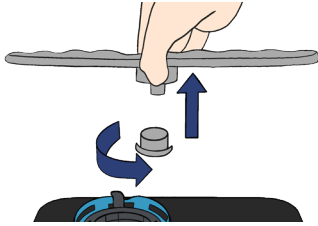

To remove the spray arm, **unscrew the ring at base of the spray arm with one hand.**

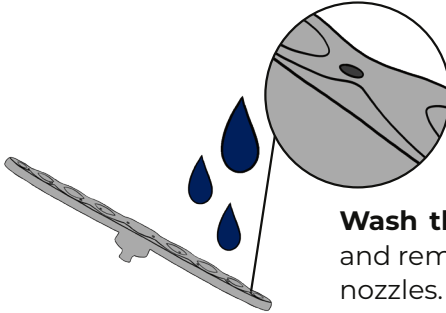

Wash the spray arm under running water and remove any food residues from the spray nozzles.

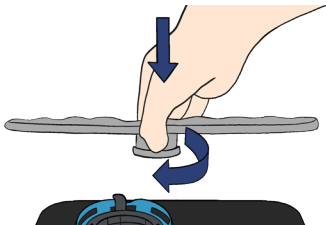

Put it back in place and make sure that nothing hinders its rotation.

QUICK TROUBLESHOOTING & AFTER SALES SERVICE GUIDE

4

1 | LIST OF POSSIBLE ISSUES

Issue	Possible causes	Known solutions
Bob does not turn on.	A fuse has blown in your electrical system or the circuit breaker has tripped.	Unplug all other appliances connected to the same electrical circuit as Bob. Replace the fuse or reset the circuit breaker.
	The power supply is not activated.	Check that the power cord is properly plugged at both ends into either the wall outlet or at Bob's side.
The cycle does not start.	Bob cassette is missing (empty or full).	Insert a Bob cassette (empty or full).
	The door is open.	Close the door.
	The door remains open, impossible to close it.	Check whether something is blocking the closing of the door. If it is not the case, please contact the After Sales Service.
	No water or not enough water in the tank.	If you are in the "integrated tank" mode: fill the tank up until the signal sounds. If you are in the "water supply" mode: check your installation (tap open, sufficient pressure).
	The screen is frozen and the buttons no longer respond.	Wait 3 seconds until Bob has started. If the screen is still frozen, disconnect and reconnect Bob.
Water does not drain out of Bob.	The drain hose is bent.	Check the drain hose and fix it with "Bob Easyfix".
	The water outlet is blocked (under the filter).	Clean the bottom of the interior and the filters.
	The drain hose is blocked by a foreign body/material.	Contact the After Sales Service.

Issue	Possible causes	Known solutions
Formation of foam inside the tank during a cycle.	Inappropriate detergent.	Only avoid special dishwasher detergent to avoid foaming. However, if this happens, open the dishwasher door and allow the foam to evaporate. Close the door and start a wash program to drain the water. Repeat the procedures if necessary.
	Soil that generates foam.	Different types of soil generate more or less foam. However, if there is too much foam during a cycle it can block the spray arm. In this case, empty the basket and run an empty cycle before you start washing your dishes again.
Stains on interior surfaces.	Limescale may appear on the surfaces.	Run a maintenance cycle at least once every 90 cycles with a rock'n'roll cassette (refer to page 64)
	I live in an area with very hard water.	Run a maintenance cycle with a rock'n'roll cassette more frequently (every 30 cycles).

Issue	Possible causes	Known solutions
The dishes are not clean.	The dishes are not placed correctly in the basket.	Avoid any contact between the different items in the basket Please refer to page 30: Recommendations for the arrangement of the dishes in the basket.
	The selected wash program is unsuitable.	Choose a more intensive program. Refer to page 42: Standard programs
	Insufficient amount of detergent, or unsuitable detergent.	Use a 'pop cassette' that ensures the best possible cleaning performance.
	The spray arm is blocked by dishes.	Change the arrangement of the dishes so that the spray arm can rotate freely.
	One or more if the spray arm nozzles is/are clogged.	Disassemble and clean the spray arm as described on page 66
	The filter are not clean or are not correctly arranged.	Disassemble and clean the filters as described on page 61.
The dishes do not properly dry.	The dishes are incorrectly arranged within the basket	Refer to page 30: Recommendation for the arrangement of the dishes in the basket.
	Insufficient amount of detergent, or unsuitable detergent.	Use a 'pop cassette' that ensures the best possible cleaning performance.
	The selected program is not suitable.	Choose a program with a longer washing time.
	The door did not open at the end of the cycle.	Check that nothing prevents the door from opening automatically at the end of the cycle.
	The dishes did not have sufficient time to dry.	Wait for the signal tone at the end of the cycle before taking out your dishes.

Issue	Possible causes	Known solutions
Emergence of water under Bob	The tank floods.	The tank capacity is 4 litres. If you are in the “integrated-tank” mode, do not overfill it. If you are in the “water supply” mode: switch your water supply off and call the After Sales Service.
	The door leaks.	Check the condition and position of the seals on the door and whether something prevents the door from closing completely.
	Leak at the drain hose connection.	Use the supplied clamp and the screwdriver to tighten the drain hose on the back of Bob. (See page 6)
	Leak at Bob's easywater connection. .	Check the connection and tighten it. (See page 5)
	Leak in the tank	Contact the After Sales Service
My dishes are damaged.	Unsuitable cycle.	Do not put any fragile cutlery in Bob(see page 30)
Damp packaging	Every Bob is tested in the factory before delivery, which is why water residues may be present.	(N/A)
The inside of Bob is humid.	Every Bob is tested in the factory before delivery,	which is why water residues may be present.
Bob is not responsive (the screen is frozen, the buttons no longer react)	Malfunctioning	Restart Bob by unplugging and then plugging it in again.

Issue	Possible causes	Known solutions
Bob Cassette cannot be inserted.	The safety caps has not yet been removed.	Remove the safety cap before inserting Bob cassette (see page 18)
	The cassette is inserted upside down.	Insert Bob cassette with the text in reading direction.
	The inside of Bob cassette's lot is blocked.	Do not put anything other than a Bob cassette in the dedicated lot. If you use a detergent other than Bob cassette, put it directly into Bob's main interior
Bob does not recognise the Bob cassette.	Communication error between the cassette and your Bob.	Take the cassette, restart your Bob and insert it again. If the problem persists, try inserting a new Bob cassette.
Bad smell (inside the tank)	Bob has not been used for a long time.	Drain your Bob completely with the emptying cycle (Settings menu), then start an empty cycle. Leave the door open at a 10° angle, if Bob is not in use.
	No maintenance cycle has been run for more then 90 cycles.	Run a maintenance cycle at least once every 90 cycles with a rock'n'roll cassette. (see page 64)

2 | REPAIR AND CUSTOMER SERVICE

All information about the repair service for Bob can be found online on our website www.daan.tech.



Scan the QR code to access our website.

All components are available for 10 years after the date of purchase of Bob.

If you have a problem with a component of your Bob, please contact the Daan Tech Customer service.

IMPORTANT:

In case a Daan Tech technician confirms that you need to return your Bob to us for analysis and repair, follow these steps:

If possible, drain your Bob completely with the emptying cycle (settings menu) Otherwise, flip Bob around

1. Otherwise, empty your Bob (especially the tank) in the sink or shower.
2. Reuse the original packaging and bag to return Bob to us. Unless otherwise instructed by our Daan Tech customer service (in written form: e-mail, SMS, etc...) you are not allowed to use any other packaging.
3. Use tape to close the package.
4. Print and paste the RETURN VOUCHER on the package (which is sent to you by email)
5. You will be informed of the progress of the repair of your Bob.

Any questions? Any recommendations?

FEEL FREE TO CONTACT US

Daan Technologies
ZA Mortier EST
85610 Cugand
France

CONTACT US BY EMAIL

Email: hello@daan.tech
After Sales Service: cs@daan.tech

PRODUCT SHEET

This product sheet complies with the European Directive No. 1059/2010.

Brand name	Bob
Product name	Bob the mini dishwasher 2020
Manufacturer name	Daan Technologies SAS
Origin of manufacturing	France (Vendée)
Number of standard place settings	2
Energy efficiency class ❶	A
Annual energy consumption ❷	98 kWh/year
Energy consumption for a standard cycle	0,35 kWh/cycle
Standby power consumption (door half-open)	0.5 W
Standby mode duration	5 minutes
Annual water consumption ❸	1064 litres
Drying performance class ❹	A
Standard cleaning cycle ❺	Eco
Duration of the standard cleaning program	90 minutes
Sound level	43 dB(A) re 1 pW
Can be used as built-in dishwasher	No
Height	49 cm (19,3 in)
Width	34 cm (13,4 in)
Depth (with cables & water inlet / outlet)	49 cm (19,3 in)
Power consumption	1000 W
Voltage & Frequency	220-240V~ 50Hz
Water pressure (water inlet)	0,5-10 bar = 0,05-1 MPa

NOTES

❶ A+++ (maximum efficiency) to D (minimum efficiency)

❷ Energy consumption of 98 kWh based on 280 standard wash cycles with cold water supply and consumption of low power modes. The actual energy consumption may differ depending on the conditions.

❸ Water consumption of 1064 litres a year based on 280 standard wash cycles. The actual energy consumption may differ depending on the conditions.

❹ A (maximum efficiency) to G (minimum efficiency)

❺ This program is suitable for cleaning medium solid dishes. It is the most efficient program in terms of the combined energy and water consumption for this type of dishwasher.

DISPOSAL



As a manufacturer, we commit to reduce the environmental footprint of our products. We highly recommend yu to follow the disposal guidelines applicable in your country. This will help preserving natural resources by recycling Bob in an eco-friendly manner. Since Bob has built-in electronic parts, it shall not be disposed with household waste, and must be discarded according to the applicable law at the time of disposal. For more information about the disposal of electronic waste, please ask your local authorities.

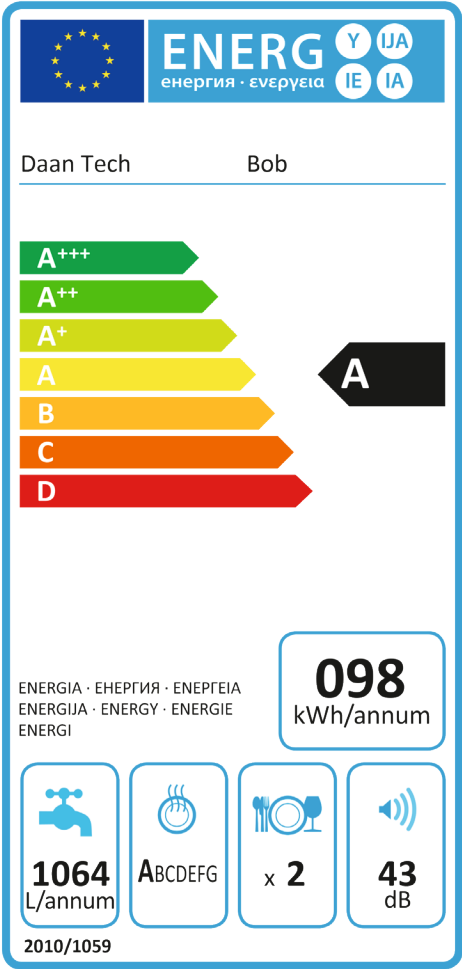

ACKNOWLEDGEMENTS

Thank you to everyone who contributed to this project:

Damian Antoine Jingwei Célestina Lancelot Céline Félix Elliot Hélène
Nicolas Kawtar Soheib Hugot Marie-Gérard Lucas Elie Luc Nicolas Dany
Jacky Guillaume Damien Emmanuel François Florian Guillaume Julien
Pauline Manuel Guillaume Laura Nicolas Davide Gilles Joël Laurence
Valérie Tristan Jean-Christophe Michel Sylviane Jacques Alain Bertrand
Gilles Vincent Matthieu Danièle Marcel Diana Philippe Bertrand François
Christine Jean-Claude Vincent Sébastien Bertrand Rémi François Damian
Loic Christian Olivier Hélène Régine Johann Philippe Camille Cyril Timothé
Guillaume Alexandra Etienne Saishashank Léo Alexandre Tanguy Lyzza
Viktoria Anna Karine Eric

And all the customers who pre-ordered Bob.

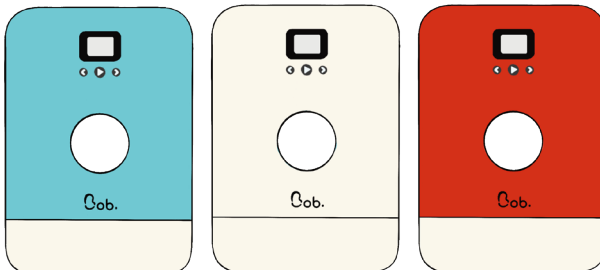

DAAN.TECH

Designing Meaningful Things

www.daan.tech

Daan Technologies SAS © ZA Mortier Est, 85610 Cugand, France

8th October 2020

English version for Europe (220- 240V ~ 50-60Hz plugs)

You are a Bob. lover?

You want to make him known by as many people as possible?
Join our Daan Tech Ambassador Program

1 I tell my relatives: family & friends how awesome Bob. is!

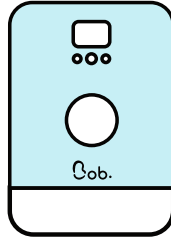

2 From my Daan Tech account, "Ambassador Referrals" tab

I offer discount coupons to people interested (referrals) by email



I share my Ambassador link

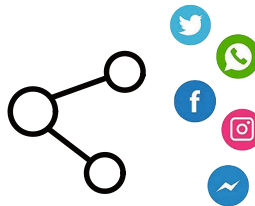

3 A simple and effective referral program to earn money by talking about Bob.

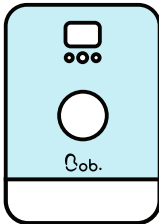

=



If someone orders a Bob through your email invitation or Ambassador link, you receive Daan Coins as a reward

Learn more on
www.daan.tech/en/ambassador-referral-program



Advantage for your referrals:



1 Daan Coin

=

5€

Convert your Daan Coins directly into money in your Daan Tech account